



**2014 Kelpie Round-Up**  
**July 18, 19, 20, 2014**

**Sanctioned by the**  
**American Herding Breeds Association**

**PackLeader Farm, Gig Harbor, WA**



**PACKLEADER**

## **Upcoming AHBA Events**

**October 11 - 12, 2014 – RLF sheep – “French Trial”**

**October 24 - 26, 2014 - HRD sheep**

**November 21 - 23, 2014 - HTAD sheep and Ducks**

**February 13 – 15, 2015 – HTD sheep and ducks**

**HTAD sheep and ducks**

**JHD**

**March 13 - 15, 2015 – HRD sheep – “Rally Trial”**

**July 17 - 19, 2015 – HRD sheep and cattle**

**HTD sheep and ducks**

**HTAD sheep and ducks**

**HCT and JHD**



# 2014 Kelpie Round-Up

## Marked Catalog

Catalog Markings: 1/90/H = 1st place/score 90/HIT  
 2/89/R = 2nd place/score 89/RHIT  
 NC/88 = Non-competitive/score 88  
 NQ = Non-qualifying; NQ/64 = Non-qualifying/score 64;  
 2/NQ/55 = 2nd place/Non-qualifying/score 55  
 A = Absent, E = Excused, D= Disqualified  
 AltNoRun = Alternate Entry Did Not Run  
 FEO/143 = For Exhibition Only/score 143

Event Date	Event Number	Herding Program	Sponsor/Location
7/18/2014	2014KelpieA	AHBA	PackLeader Farm PackLeader Farm Gig Harbor, WA
7/19/2014	2014KelpieB	AHBA	PackLeader Farm PackLeader Farm Gig Harbor, WA
7/20/2014	2014KelpieC	AHBA	PackLeader Farm PackLeader Farm Gig Harbor, WA

### Trial Committee

Position	Member	Address - Email
Trial Chairperson	Davenport, Barbara	14401 Crews Rd KPN, Gig Harbor, WA 98329 k9sayno@aol.com
Trial Secretary 1	Wright, Ashley	2605 North Winnifred Rd., Tacoma, WA 98407 wrightaa1@gmail.com
Trial Secretary 2	Chalk, Vicki	P. O. Box 206, Puyallup, WA 98371-0022 vchalk@comcast.net
Chief Stock Handler	Davenport, Barbara	14401 Crews Rd KPN, Gig Harbor, WA 98329 k9sayno@aol.com
Course Director	Wright, Ashley	2605 North Winnifred Rd., Tacoma, WA 98407 wrightaa1@gmail.com
Hospitality	Branin, Karen	14304 Glenwood Rd SW, Port Oechard, WA 98367 Kandgbranin@msn.com
Judge 1	Kenney, Terry	P.O.Box 742, Leona Valley, CA 93551 herdem@aol.com
Judge 2	McDonnell, Gina	81071 Cherrydale Rd, RR4, Goderich, ON N7A3Y1
Judge 3	Larson, David	380 S. Military Rd., Winlock, WA 98596 live4k9s@gmail.com
Judge 4	Davenport, Barbara	14401 Crews Rd KPN, Gig Harbor, WA 98329 k9sayno@aol.com

# 2014 Kelpie Round-Up

## Class Schedule and Run Order

Check-in starting @ 0630. General Meeting @ 0700. HRD walk-thru at 0715. Lunch break at 1200 and/or between classes.  
Test classes will follow lunch regardless of where we are in the schedule.

**Friday, July 18, 2014**

### Judging Group A

Course	Stock	Class	Judge	Entry Cnt
--------	-------	-------	-------	-----------

**Est. Start Time : 7:30 AM**

<b>HRD</b>	<b>Sheep</b>	<b>III</b>	<b>Terry Kenney</b>	<b>(6)</b>
------------	--------------	------------	---------------------	------------

- 1) 1315 - Doyle / Jillian ( Aussie)
- 2) 1322 - Madamba / Boomer ( Aust Kelp)
- 3) 1304 - Wright / Isis ( BC)
- 4) 1302 - Davenport / Tori ( Aust Kelp)
- 5) 1314 - Godfrey / Singer ( GSD)
- 6) 1308 - Frost / Carma ( Rott)

<b>HRD</b>	<b>Sheep</b>	<b>II</b>	<b>Terry Kenney</b>	<b>(3)</b>
------------	--------------	-----------	---------------------	------------

- 1) 1213 - Bradley / Sugar ( ACD)
- 2) 1220 - Garard / Lakota ( ACD)
- 3) 1203 - Wright / McGee ( Aust Kelp)

<b>HRD</b>	<b>Sheep</b>	<b>I</b>	<b>Terry Kenney</b>	<b>(1)</b>
------------	--------------	----------	---------------------	------------

- 1) 1133 - Davenport / Rooster ( Aust Kelp)

<b>JHD</b>	<b>Sheep</b>	<b>JHD</b>	<b>Terry Kenney</b>	<b>(2)</b>
------------	--------------	------------	---------------------	------------

- 1) 136 - Garard / Nikita ( ACD)
- 2) 137 - Bell / Tandie ( ACD)

<b>HTD</b>	<b>Sheep</b>	<b>III</b>	<b>Terry Kenney</b>	<b>(4)</b>
------------	--------------	------------	---------------------	------------

- 1) 3315 - Doyle / Jillian ( Aussie)
- 2) 3314 - Godfrey / Singer ( GSD)
- 3) 3302 - Davenport / Tori ( Aust Kelp)
- 4) 3304 - Wright / Isis ( BC)

<b>HTD</b>	<b>Sheep</b>	<b>II</b>	<b>Terry Kenney</b>	<b>(2)</b>
------------	--------------	-----------	---------------------	------------

- 1) 3222 - Madamba / Boomer ( Aust Kelp)
- 2) 3227 - MacDonald / Laddie ( BC)

<b>HTD</b>	<b>Sheep</b>	<b>I</b>	<b>Terry Kenney</b>	<b>(2)</b>
------------	--------------	----------	---------------------	------------

- 1) 3113 - Bradley / Sugar ( ACD)
- 2) 3103 - Wright / McGee ( Aust Kelp)

<b>HTD</b>	<b>Ducks</b>	<b>III</b>	<b>Terry Kenney</b>	<b>(3)</b>
------------	--------------	------------	---------------------	------------

- 1) 4309 - Kelly / Kate ( BC)
- 2) 4302 - Davenport / Tori ( Aust Kelp)
- 3) 4335 - McGee / Spur ( Aussie)

**Friday, July 18, 2014**

### Judging Group A

Course	Stock	Class	Judge	Entry Cnt
--------	-------	-------	-------	-----------

<b>HTD</b>	<b>Ducks</b>	<b>I</b>	<b>Terry Kenney</b>	<b>(2)</b>
------------	--------------	----------	---------------------	------------

- 1) 4113 - Bradley / Sugar ( ACD)
- 2) 4133 - Davenport / Rooster ( Aust Kelp)

<b>HCT</b>	<b>Sheep</b>	<b>HCT</b>	<b>Terry Kenney</b>	<b>(1)</b>
------------	--------------	------------	---------------------	------------

- 1) 324 - Starr / Layla ( ACD)

### Judging Group B

Course	Stock	Class	Judge	Entry Cnt
--------	-------	-------	-------	-----------

**Est. Start Time : 9:30 AM**

<b>HCT</b>	<b>Sheep</b>	<b>HCT</b>	<b>Barbara Davenport</b>	<b>(1)</b>
------------	--------------	------------	--------------------------	------------

- 1) 224 - Starr / Layla ( ACD)

<b>HTAD3</b>	<b>Ducks</b>	<b>III</b>	<b>Barbara Davenport</b>	<b>(3)</b>
--------------	--------------	------------	--------------------------	------------

- 1) 6306 - Rice / Bean ( ACD)
- 2) 6314 - Godfrey / Singer ( GSD)
- 3) 6304 - Wright / Isis ( BC)

<b>HTAD3</b>	<b>Ducks</b>	<b>II</b>	<b>Barbara Davenport</b>	<b>(1)</b>
--------------	--------------	-----------	--------------------------	------------

- 1) 6208 - Frost / Carma ( Rott)

<b>HTAD3</b>	<b>Ducks</b>	<b>I</b>	<b>Barbara Davenport</b>	<b>(1)</b>
--------------	--------------	----------	--------------------------	------------

- 1) 6113 - Bradley / Sugar ( ACD)

<b>HTAD4</b>	<b>Sheep</b>	<b>III</b>	<b>Barbara Davenport</b>	<b>(7)</b>
--------------	--------------	------------	--------------------------	------------

- 1) 5309 - Kelly / Kate ( BC)
- 2) 5308 - Frost / Carma ( Rott)
- 3) 5306 - Rice / Bean ( ACD)
- 4) 5314 - Godfrey / Singer ( GSD)
- 5) 5304 - Wright / Isis ( BC)
- 6) 5335 - McGee / Spur ( Aussie)
- 7) 5334 - Frost / Cosmo ( Rott)

<b>HTAD4</b>	<b>Sheep</b>	<b>II</b>	<b>Barbara Davenport</b>	<b>(4)</b>
--------------	--------------	-----------	--------------------------	------------

- 1) 5220 - Garard / Lakota ( ACD)
- 2) 5213 - Bradley / Sugar ( ACD)
- 3) 5222 - Madamba / Boomer ( Aust Kelp)
- 4) 5203 - Wright / McGee ( Aust Kelp)

## 2014 Kelpie Round-Up

7/27/2014

## PackLeader Farm

Friday, July 18, 2014

AHBA

Event# 2014KelpieA

HRD III Sheep Judge: Terry Kenney

- 4/90** **1315 Legends I Hope You Dance (Jillian)**  
 ASCA E172422, DOB: 1/6/2011, Australian Shepherd, Sex: F, Breeder: Anne and Steve Shope Sire: Graingers  
 Everredy Legends Edi Dam: Legends Starn Say Gnite Gracie Owner(s): Raenell Doyle, P.O. Box 517, Yelm WA 98597
- 78** **1322 DeHaro's Boomerang JHDs HRDIs HRDIIs HTADIs HTDIs (Boomer)**  
 WKCA S3M-3857 NIL(S4), DOB: 3/30/2011, Australian Kelpie, Sex: M, Breeder: Rick Pinney Sire: Santolina Sam  
 Dam: DeHaro's Nell Owner(s): Shari Madamba, 7323 66th Dr. NE, Marysville WA 98270
- 2/94.5/R** **1304 Chesta's Isis of Callaway HRDIs HRDIIs HTADId HTADIIIs HTDIs RLFIIIs (Isis)**  
 AKC PAL257146, DOB: 10/19/2009, Border Collie, Sex: F, Breeder: Unknown Sire: Unknown Dam: Unknown  
 Owner(s): Ashley Wright, 2605 North Winnifred Rd., Tacoma WA 98407
- 83.5** **1302 Marionvale Tori HRDIIs HTADIs HTDIsd RLFI (Tori)**  
 WKCA A3F-18308-09MRV(A19), DOB: 11/20/2009, Australian Kelpie, Sex: F, Breeder: Simon Leaning Sire:  
 Marionvale Alby Dam: Marionvale Rose Owner(s): Barbara Davenport, 14401 Crews Rd KPN, Gig Harbor WA 98329
- 3/93** **1314 Alta Tollhaus Just a Singer (Singer)**  
 AKC DN26948001, DOB: 12/24/2009, German Shepherd Dog, Sex: M, Breeder: Julie Richards-Mostosky Sire: X Bo  
 Dei Precision Dam: Faye Vom Kinschental Owner(s): Richard Godfrey, Janis Godfrey 4172 Black Mountain Rd, La Mesa  
 CA 91941
- 1/94.5/H** **1308 Frost-King Carma HRDIIs HTADIsd HTDId RLFIs HRDIc HTADIIIs (Carma)**  
 AKC WS35129405, DOB: 7/19/2010, Rottweiler, Sex: F, Breeder: Pamela Frost Sire: BISS CH Pepperhaus  
 Praetorian CD Dam: Frost-King Bewitched HRDIs HTADId HSAdsc Owner(s): Pamela Frost, 23110 NE Chelatchie Rd,  
 Amboy WA 98601

HRD II Sheep Judge: Terry Kenney

- NQ** **1213 That'l Du's Sweet New Moon (Sugar)**  
 AKC DN24656702, DOB: 4/2/2009, Australian Cattle Dog, Sex: F, Breeder: Linda Bell Sire: Ray's Blue Bandit  
 Ralph Dam: CH Austlyn's Thatldu's Hi Voltage Owner(s): Kent Bradley, 12615 S Salnave Road, Medical Lake WA  
 99022
- 2/67** **1220 Bar H Pistol Packing Lakota Cowgirl (Lakota)**  
 AKC DN27651404, DOB: 4/3/2010, Australian Cattle Dog, Sex: F, Breeder: Lisa & Jesse Hampton Sire: Ch. Jabaluk  
 Cattle Buck Dam: Ch Castle Butte Bindi RA HSAS NA OAJ Owner(s): Shawna Garard, 28811 SE Hwy 224, Eagle Cree  
 OR 97022
- 1/81.5** **1203 CLK Oakley HRDIs HTADIsd HTDId (McGee)**  
 NAAKR K04407, DOB: 12/15/2009, Australian Kelpie, Sex: M, Breeder: Kelly Orr Sire: CLK Buckle Dam: CLK Chi  
 Chi Owner(s): Ashley Wright, 2605 North Winnifred Rd., Tacoma WA 98407

HRD I Sheep Judge: Terry Kenney

- 1/83** **1133 CLK Rooster JHD HTDIs HTADIs (Rooster)**  
 NAAKR K04409, DOB: 1/2/2010, Australian Kelpie, Sex: M, Breeder: Kellp Orr Sire: Moo Hollow Twisp Dam: CLK  
 Cooi Owner(s): Stephen Weigley, 14401 Crews Rd. KPN, Gig Harbor WA 98329 Handler: Barbara Davenport

JHD JHD Sheep Judge: Terry Kenney

- Q** **136 Hillhaven Nikita Gun Powder and Lace (Nikita)**  
 AKC DN37513003, DOB: 7/25/2013, Australian Cattle Dog, Sex: F, Breeder: Louanne, James, and Amelia Brooks  
 Sire: GCH CH Hillhaven Journey The Rapids HSADs Dam: CH Hillhaven Viva La Vie Owner(s): Shawna Garard, 28811 SE  
 Hwy 224, Eagle Creek OR 97022

# 2014 Kelpie Round-Up

7/27/2014

## PackLeader Farm

Friday, July 18, 2014

AHBA

Event# 2014KelpieA

JHD JHD Sheep Judge: Terry Kenney

Q **137 Austlyn's Thisaway Thataway (Tandie)**  
 CKC 1124566, DOB: 6/9/2013, Australian Cattle Dog, Sex: F, Breeder: Lynda Rockvold Sire: Can/Am CH Aquila's Ready Aim Fire HTs PTs Dam: Austlyn's Lifes a Song Owner(s): Marilyn Bell, 3762 Sooke Road, Victoria BC V9C4B8

HTD III Sheep Judge: Terry Kenney

2/83 **3315 Legends I Hope You Dance (Jillian)**  
 ASCA E172422, DOB: 1/6/2011, Australian Shepherd, Sex: F, Breeder: Anne and Steve Shope Sire: Graingers Everredy Legends Edi Dam: Legends Starn Say Gnite Gracie Owner(s): Raenell Doyle, P.O. Box 517, Yelm WA 98597

NQ **3314 Alta Tollhaus Just a Singer (Singer)**  
 AKC DN26948001, DOB: 12/24/2009, German Shepherd Dog, Sex: M, Breeder: Julie Richards-Mostosky Sire: X Bo Dei Precision Dam: Faye Vom Kinschental Owner(s): Richard Godfrey, Janis Godfrey 4172 Black Mountain Rd, La Mesa CA 91941

1/84.5 **3302 Marionvale Tori HRDIIs HTADIIs HTDIId RLFI (Tori)**  
 WKCA A3F-18308-09MRV(A19), DOB: 11/20/2009, Australian Kelpie, Sex: F, Breeder: Simon Leaning Sire: Marionvale Alby Dam: Marionvale Rose Owner(s): Barbara Davenport, 14401 Crews Rd KPN, Gig Harbor WA 98329

3/82 **3304 Chesta's Isis of Callaway HRDIIs HRDIIs HTADIId HTADIIs HTDIIs RLFIIIs (Isis)**  
 AKC PAL257146, DOB: 10/19/2009, Border Collie, Sex: F, Breeder: Unknown Sire: Unknown Dam: Unknown Owner(s): Ashley Wright, 2605 North Winnifred Rd., Tacoma WA 98407

HTD II Sheep Judge: Terry Kenney

2/81 **3222 DeHaro's Boomerang JHDs HRDIIs HRDIIs HTADIIs HTDIIs (Boomer)**  
 WKCA S3M-3857 NIL(S4), DOB: 3/30/2011, Australian Kelpie, Sex: M, Breeder: Rick Pinney Sire: Santolina Sam Dam: DeHaro's Nell Owner(s): Shari Madamba, 7323 66th Dr. NE, Marysville WA 98270

1/83 **3227 Laddie (Laddie)**  
 ABCA 382248, DOB: 8/15/2012, Border Collie, Sex: M, Breeder: Sue McDonald Sire: Nap Dam: Deltablz Jackie Owner(s): Susan Risner, PO Box 86, Port Orchard WA 98366 Handler: Sue MacDonald

HTD I Sheep Judge: Terry Kenney

NQ **3113 That'l Du's Sweet New Moon (Sugar)**  
 AKC DN24656702, DOB: 4/2/2009, Australian Cattle Dog, Sex: F, Breeder: Linda Bell Sire: Ray's Blue Bandit Ralph Dam: CH Austlyn's Thatldu's Hi Voltage Owner(s): Kent Bradley, 12615 S Salnave Road, Medical Lake WA 99022

1/74 **3103 CLK Oakley HRDIIs HTADIId HTDIId (McGee)**  
 NAAKR K04407, DOB: 12/15/2009, Australian Kelpie, Sex: M, Breeder: Kelly Orr Sire: CLK Buckle Dam: CLK Chi Chi Owner(s): Ashley Wright, 2605 North Winnifred Rd., Tacoma WA 98407

HTD III Ducks Judge: Terry Kenney

1/82 **4309 Kate (Kate)**  
 ASCA T6208, DOB: 3/20/2010, Border Collie, Sex: F, Breeder: Unknown Sire: Unknown Dam: Unknown Owner(s): Kelly L. Kelly, 15113 61st St E, Sumner WA 98390

NQ **4302 Marionvale Tori HRDIIs HTADIIs HTDIId RLFI (Tori)**  
 WKCA A3F-18308-09MRV(A19), DOB: 11/20/2009, Australian Kelpie, Sex: F, Breeder: Simon Leaning Sire: Marionvale Alby Dam: Marionvale Rose Owner(s): Barbara Davenport, 14401 Crews Rd KPN, Gig Harbor WA 98329

# 2014 Kelpie Round-Up

7/27/2014

## PackLeader Farm

Friday, July 18, 2014

AHBA

Event# 2014KelpieA

HTD III Ducks Judge: Terry Kenney

2/NQ/66 **4335 Mikatura's Saddles 'N'Spurs (Spur)**  
 ASCA E147557, DOB: 4/11/2006, Australian Shepherd, Sex: F, Breeder: Foss Gallichan Sire: Mikatura's Tuff-E-Nuff Dam: Mikatura's Saddle Ridge Owner(s): Susan McGee, 34128 NE Stossel Creek Way, Duvall WA 98019

HTD I Ducks Judge: Terry Kenney

NQ **4113 That'I Du's Sweet New Moon (Sugar)**  
 AKC DN24656702, DOB: 4/2/2009, Australian Cattle Dog, Sex: F, Breeder: Linda Bell Sire: Ray's Blue Bandit Ralph Dam: CH Austlyn's Thatldu's Hi Voltage Owner(s): Kent Bradley, 12615 S Salnave Road, Medical Lake WA 99022

1/79 **4133 CLK Rooster JHD HTDIs HTADIs (Rooster)**  
 NAAKR K04409, DOB: 1/2/2010, Australian Kelpie, Sex: M, Breeder: Kellp Orr Sire: Moo Hollow Twisp Dam: CLK Cooi Owner(s): Stephen Weigley, 14401 Crews Rd. KPN, Gig Harbor WA 98329 Handler: Barbara Davenport

HCT HCT Sheep Judge: Terry Kenney

Q **324 So-Lo's Layla Blues Dancer (Layla)**  
 AKC DN26653503, DOB: 12/5/2009, Australian Cattle Dog, Sex: F, Breeder: Alice Kapelos & Armendine Berry Sire: So-Lo's Greystones Rock Dam: Lassic Pistol in a Petticoat Owner(s): Tess Starr, 3727 163rd Ave SW, Tenino WA 98589

HCT HCT Sheep Judge: Barbara Davenport

Q **224 So-Lo's Layla Blues Dancer (Layla)**  
 AKC DN26653503, DOB: 12/5/2009, Australian Cattle Dog, Sex: F, Breeder: Alice Kapelos & Armendine Berry Sire: So-Lo's Greystones Rock Dam: Lassic Pistol in a Petticoat Owner(s): Tess Starr, 3727 163rd Ave SW, Tenino WA 98589

HTAD3 III Ducks Judge: Barbara Davenport

NQ **6306 The Bean (Bean)**  
 AKC PAL201058, DOB: 10/25/2005, Australian Cattle Dog, Sex: F, Breeder: unknown Sire: unknown Dam: Charlotte Owner(s): Jen Rice, 6215 47th Ave S, Seattle WA 98118

2/84 **6314 Alta Tollhaus Just a Singer (Singer)**  
 AKC DN26948001, DOB: 12/24/2009, German Shepherd Dog, Sex: M, Breeder: Julie Richards-Mostosky Sire: X Bo Dei Precision Dam: Faye Vom Kinschental Owner(s): Richard Godfrey, Janis Godfrey 4172 Black Mountain Rd, La Mesa CA 91941

1/85 **6304 Chesta's Isis of Callaway HRDIs HRDIIs HTADId HTADIIIs HTDIs RLFIIIs (Isis)**  
 AKC PAL257146, DOB: 10/19/2009, Border Collie, Sex: F, Breeder: Unknown Sire: Unknown Dam: Unknown Owner(s): Ashley Wright, 2605 North Winnifred Rd., Tacoma WA 98407

HTAD3 II Ducks Judge: Barbara Davenport

1/78.5 **6208 Frost-King Carma HRDIIs HTADIsd HTDId RLFIs HRDIc HTADIIIs (Carma)**  
 AKC WS35129405, DOB: 7/19/2010, Rottweiler, Sex: F, Breeder: Pamela Frost Sire: BISS CH Pepperhaus Praetorian CD Dam: Frost-King Bewitched HRDIs HTADId HSAdsc Owner(s): Pamela Frost, 23110 NE Chelatchie Rd, Amboy WA 98601

## 2014 Kelpie Round-Up

7/27/2014

## PackLeader Farm

Friday, July 18, 2014

AHBA

Event# 2014KelpieA

HTAD3 I Ducks Judge: Barbara Davenport

1/73 6113 That'I Du's Sweet New Moon (Sugar)

AKC DN24656702, DOB: 4/2/2009, Australian Cattle Dog, Sex: F, Breeder: Linda Bell Sire: Ray's Blue Bandit Ralph Dam: CH Austlyn's Thatldu's Hi Voltage Owner(s): Kent Bradley, 12615 S Salnave Road, Medical Lake WA 99022

HTAD4 III Sheep Judge: Barbara Davenport

4/89.5 5309 Kate (Kate)

ASCA T6208, DOB: 3/20/2010, Border Collie, Sex: F, Breeder: Unknown Sire: Unknown Dam: Unknown Owner(s): Kelly L. Kelly, 15113 61st St E, Sumner WA 98390

2/92 5308 Frost-King Carma HRDIIs HTADId HTDId RLFIs HRDIc HTADIIIs (Carma)

AKC WS35129405, DOB: 7/19/2010, Rottweiler, Sex: F, Breeder: Pamela Frost Sire: BISS CH Pepperhaus Praetorian CD Dam: Frost-King Bewitched HRDI HTADId HSAdsc Owner(s): Pamela Frost, 23110 NE Chelatchie Rd, Amboy WA 98601

83.5 5306 The Bean (Bean)

AKC PAL201058, DOB: 10/25/2005, Australian Cattle Dog, Sex: F, Breeder: unknown Sire: unknown Dam: Charlotte Owner(s): Jen Rice, 6215 47th Ave S, Seattle WA 98118

3/90 5314 Alta Tollhaus Just a Singer (Singer)

AKC DN26948001, DOB: 12/24/2009, German Shepherd Dog, Sex: M, Breeder: Julie Richards-Mostosky Sire: X Bo Dei Precision Dam: Faye Vom Kinschental Owner(s): Richard Godfrey, Janis Godfrey 4172 Black Mountain Rd, La Mesa CA 91941

89 5304 Chesta's Isis of Callaway HRDIIs HRDIIs HTADId HTADIIIs HTDIIs RLFIIIs (Isis)

AKC PAL257146, DOB: 10/19/2009, Border Collie, Sex: F, Breeder: Unknown Sire: Unknown Dam: Unknown Owner(s): Ashley Wright, 2605 North Winnifred Rd., Tacoma WA 98407

85 5335 Mikatura's Saddles 'N' Spurs (Spur)

ASCA E147557, DOB: 4/11/2006, Australian Shepherd, Sex: F, Breeder: Foss Gallichan Sire: Mikatura's Tuff-E-Nuff Dam: Mikatura's Saddle Ridge Owner(s): Susan McGee, 34128 NE Stossel Creek Way, Duvall WA 98019

1/94 5334 Frost-King Cosmo HRDIIs HTDIIId RLFIs HTADIIIsd (Cosmo)

AKC WS35129401, DOB: 7/19/2010, Rottweiler, Sex: M, Breeder: Pamela Frost Sire: BISS CH Pepperhaus Praetorian CD Dam: Frost-King Bewitched HRDI HTADId HSAdsc JHD Owner(s): Pamela Frost, Art King 23110 NE Chelatchie Rd, Amboy WA 98601

HTAD4 II Sheep Judge: Barbara Davenport

NQ 5220 Bar H Pistol Packing Lakota Cowgirl (Lakota)

AKC DN27651404, DOB: 4/3/2010, Australian Cattle Dog, Sex: F, Breeder: Lisa & Jesse Hampton Sire: Ch. Jabaluk Cattle Buck Dam: Ch Castle Butte Bindi RA HSAS NA OAJ Owner(s): Shawna Garard, 28811 SE Hwy 224, Eagle Creek OR 97022

2/78 5213 That'I Du's Sweet New Moon (Sugar)

AKC DN24656702, DOB: 4/2/2009, Australian Cattle Dog, Sex: F, Breeder: Linda Bell Sire: Ray's Blue Bandit Ralph Dam: CH Austlyn's Thatldu's Hi Voltage Owner(s): Kent Bradley, 12615 S Salnave Road, Medical Lake WA 99022

3/75.5 5222 DeHaro's Boomerang JHDs HRDIIs HRDIIs HTADIs HTDIIs (Boomer)

WKCA S3M-3857 NIL(S4), DOB: 3/30/2011, Australian Kelpie, Sex: M, Breeder: Rick Pinney Sire: Santolina Sam Dam: DeHaro's Nell Owner(s): Shari Madamba, 7323 66th Dr. NE, Marysville WA 98270



# 2014 Kelpie Round-Up

7/27/2014

PackLeader Farm

Friday, July 18, 2014

AHBA

Event# 2014KelpieA

HTAD4 II

Sheep

Judge: Barbara Davenport

1/79

**5203** CLK Oakley HRDIs HTADIsd HTDId (McGee)

NAAKR K04407, DOB: 12/15/2009, Australian Kelpie, Sex: M, Breeder: Kelly Orr Sire: CLK Buckle Dam: CLK Chi Chi Owner(s): Ashley Wright, 2605 North Winnifred Rd., Tacoma WA 98407

## Trial Awards - Event 2014KelpieA

**HIT :** 94.5 Frost-King Carma (Carma)

1308 Course HRD III Sheep

**RHIT:** 94.5 Chesta's Isis of Callaway (Isis)

1304 Course HRD III Sheep

## JULY 18<sup>th</sup>, 2014 – SHEEP Course #1

### GENERAL RULES:

- Time 20 minutes.
- In all elements, quiet efficient stock work is essential.
- All elements must be attempted prior to moving on.
- All gates may be open/closed or pre-set at the Handler's discretion (unless specified)
- Time will not end until all gates have been restored to their original/starting position.
- Ties are broken based on individual scores in the following order: Exercise 3 "Sort/Small Pens", Exercise 5 "Obstacle #2", Time.

### STARTING SET- UP:

- All gates must be returned to the starting positions.
- 10 sheep in Stockyard, 2 sets of 5 sheep in Alley C/D, 6 sets of 5 sheep in Reserve.

- 1. GATHER - HRDI/II: 15 pts., HRDIII: 25 pts.:** Enter Arena A through the designated 4' gate and open Pen #1 gate to the arena. Move to the position appropriate for the team's level. Gather sheep from Stockyard and move them into Arena A. HRDI & II - Exercise ends when the gate to Arena A is closed. HRDIII – Exercise ends when the sheep enter Arena A (Stock handler will close the gate between Arena A and Pen #1 for HRDIII Handlers once the sheep/team has exited the arena – section #3).
  - **HRDI** Dog is left approximately halfway to sheep's position, Handler may move within 15 feet of sheep
  - **HRDII** Dog is left at the Handler's Post, Handler may move ½ way (Pen #1).
  - **HRDIII** Team begins at the Handler's Post, where the Handler remains until the dog is sent. Once the dog is sent, the handler may move within the designated Advanced Handler's Zone.
- 2. OBSTACLE #1 – 15 pts.:** Move sheep through Obstacle #1. HRDI & II handlers may move anywhere. HRDIII handlers remain at the entrance until the sheep have cleared the exit. Exercise ends when the sheep exit the Advanced Handler's Zone toward Pen #2.
- 3. SORT/SMALL PENS - 20 pts.:** Sort sheep into 2 groups of 5 using any combination of gates associated with Pen #2. Move sorted sheep to vacant pens in Alley C/D. Remove 10 sheep from designated pens and move them to Pen #2. Exercise ends when Pen #2 gate is closed.
- 4. FETCH/DRIVE - 20 pts.:** Move the sheep into the Back Alley and Fetch/Drive them through Pen #5 and into Arena A. Exercise ends when sheep enters Arena A through the north gate.
  - **HRDI** Handler may move anywhere
  - **HRDII** Handler enters Arena A from Pen #2 and may move anywhere up to, and including, the Advanced Handler's Zone until the sheep have passed the marker. Once the sheep have passed the maker handler may move anywhere in Arena A.
  - **HRDIII** Handler enters Arena A from Pen #2 and moves to the Advanced Handler's Zone until the sheep enter Arena A.
- 5. OBSTACLE #2 - 10 pts.:** Move sheep down the arena and through Obstacle #2 in a controlled manner. Exercise ends when the sheep clear Obstacle #2.
- 6. REPEN - 10 pts.:** Move sheep to Pen #1, hold stock off gate and re-pen. Exercise ends when the gate to Pen #1 is closed.

Time stops when **ALL** gates have been restored to their original/starting position.

2014 Kelpie Round-Up  
AHBA HRD - SHEEP Course #1

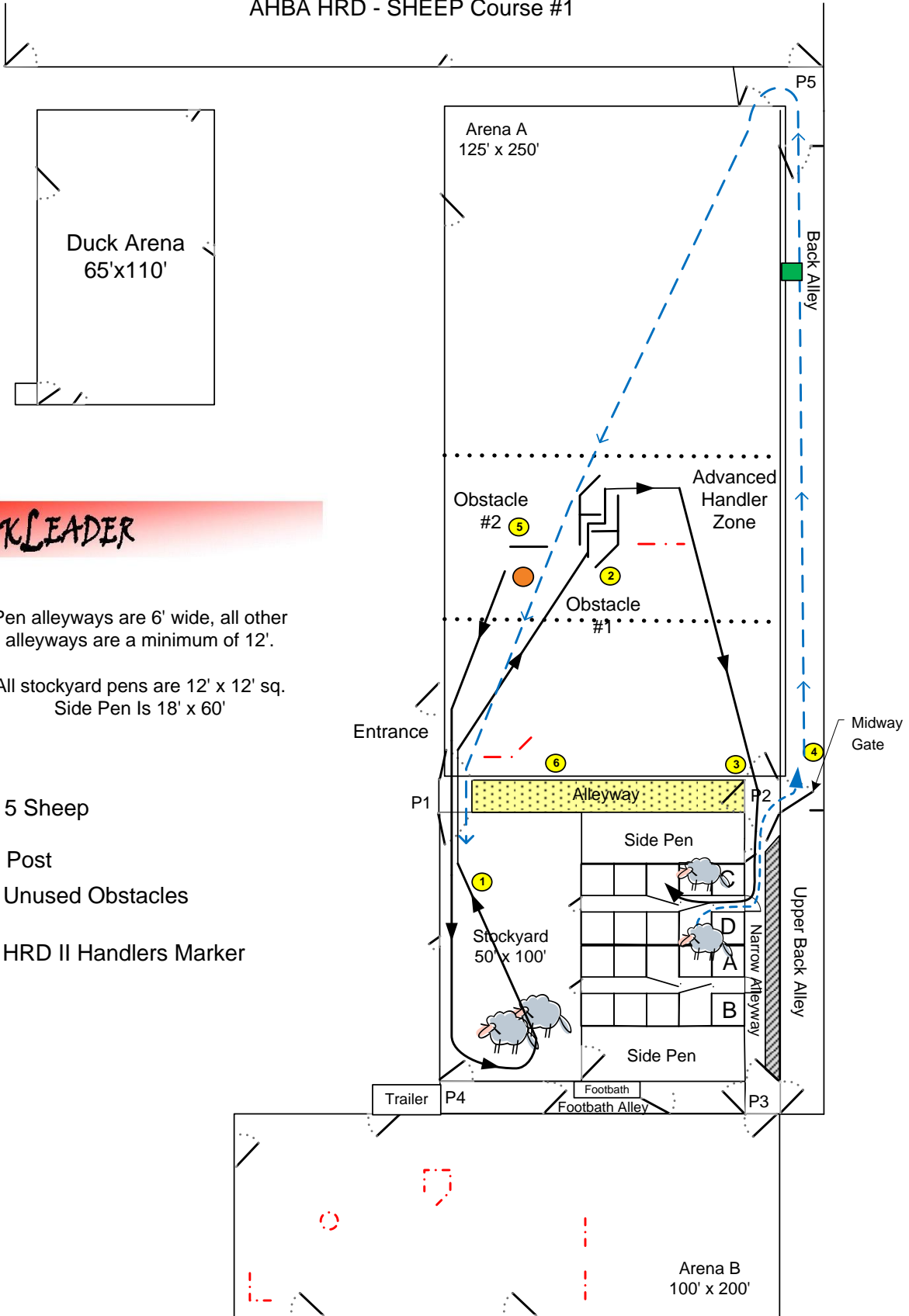

Pen alleyways are 6' wide, all other alleyways are a minimum of 12'.

All stockyard pens are 12' x 12' sq.  
Side Pen Is 18' x 60'

 = 5 Sheep

 = Post

 = Unused Obstacles

 = HRD II Handlers Marker

# 2014 Kelpie Round-Up

## Class Schedule and Run Order

Check-in starting @ 0630. General Meeting @ 0700. HRD walk-thru at 0715. Lunch break at 1200 and/or between classes.  
Test classes will follow lunch regardless of where we are in the schedule.

**Saturday, July 19, 2014**

### Judging Group A

Course	Stock	Class	Judge	Entry Cnt
--------	-------	-------	-------	-----------

**Est. Start Time : 10:00 AM**

<b>HRD</b>	<b>Cattle</b>	<b>III</b>	<b>Terry Kenney</b>	<b>(5)</b>
------------	---------------	------------	---------------------	------------

- 1) 2305 - Rice / Louie ( BC)
- 2) 2311 - Gann / Bindi ( ACD)
- 3) 2319 - Larson / Denali ( Aust Kelp)
- 4) 2310 - Murray / Koz ( ACD)
- 5) 2301 - Davenport / Tempe ( Aust Kelp)

<b>HRD</b>	<b>Cattle</b>	<b>II</b>	<b>Terry Kenney</b>	<b>(1)</b>
------------	---------------	-----------	---------------------	------------

- 1) 2218 - Shobert / Red ( Aussie)

<b>HRD</b>	<b>Cattle</b>	<b>I</b>	<b>Terry Kenney</b>	<b>(9)</b>
------------	---------------	----------	---------------------	------------

- 1) 2102 - Davenport / Tori ( Aust Kelp)
- 2) 2113 - Bradley / Sugar ( ACD)
- 3) 2103 - Wright / McGee ( Aust Kelp)
- 4) 2106 - Rice / Bean ( ACD)
- 5) 2122 - Madamba / Boomer ( Aust Kelp)
- 6) 2120 - Garard / Lakota ( ACD)
- 7) 2104 - Wright / Isis ( BC)
- 8) 2133 - Davenport / Rooster ( Aust Kelp)
- 9) 2108 - Frost / Carma ( Rott)

<b>JHD</b>	<b>Sheep</b>	<b>JHD</b>	<b>Terry Kenney</b>	<b>(2)</b>
------------	--------------	------------	---------------------	------------

- 1) 426 - Turner / Fry ( BC)
- 2) 438 - Rice / Freya ( ASTCD)

<b>HTAD3</b>	<b>Ducks</b>	<b>III</b>	<b>Terry Kenney</b>	<b>(3)</b>
--------------	--------------	------------	---------------------	------------

- 1) 6314 - Godfrey / Singer ( GSD)
- 2) 6306 - Rice / Bean ( ACD)
- 3) 6304 - Wright / Isis ( BC)

<b>HTAD3</b>	<b>Ducks</b>	<b>II</b>	<b>Terry Kenney</b>	<b>(1)</b>
--------------	--------------	-----------	---------------------	------------

- 1) 6208 - Frost / Carma ( Rott)

<b>HTAD3</b>	<b>Ducks</b>	<b>I</b>	<b>Terry Kenney</b>	<b>(2)</b>
--------------	--------------	----------	---------------------	------------

- 1) 6113 - Bradley / Sugar ( ACD)
- 2) 6133 - Davenport / Rooster ( Aust Kelp)

<b>HTAD4</b>	<b>Sheep</b>	<b>III</b>	<b>Terry Kenney</b>	<b>(8)</b>
--------------	--------------	------------	---------------------	------------

- 1) 5309 - Kelly / Kate ( BC)

**Saturday, July 19, 2014**

### Judging Group A

Course	Stock	Class	Judge	Entry Cnt
--------	-------	-------	-------	-----------

<b>HTAD4</b>	<b>Sheep</b>	<b>III</b>	<b>Terry Kenney</b>	<b>(8)</b>
--------------	--------------	------------	---------------------	------------

- 2) 5314 - Godfrey / Singer ( GSD)
- 3) 5308 - Frost / Carma ( Rott)
- 4) 5306 - Rice / Bean ( ACD)
- 5) 5319 - Larson / Denali ( Aust Kelp)
- 6) 5304 - Wright / Isis ( BC)
- 7) 5334 - Frost / Cosmo ( Rott)
- 8) 5311 - Murray-Gann / Bindi ( ACD)

<b>HTAD4</b>	<b>Sheep</b>	<b>II</b>	<b>Terry Kenney</b>	<b>(4)</b>
--------------	--------------	-----------	---------------------	------------

- 1) 5213 - Bradley / Sugar ( ACD)
- 2) 5220 - Garard / Lakota ( ACD)
- 3) 5222 - Madamba / Boomer ( Aust Kelp)
- 4) 5203 - Wright / McGee ( Aust Kelp)

<b>HTAD4</b>	<b>Sheep</b>	<b>I</b>	<b>Terry Kenney</b>	<b>(2)</b>
--------------	--------------	----------	---------------------	------------

- 1) 5107 - Rice / Sully ( ACD)
- 2) 5139 - Gann / Briar ( Aussie)

### Judging Group B

Course	Stock	Class	Judge	Entry Cnt
--------	-------	-------	-------	-----------

**Est. Start Time : 7:30 AM**

<b>HRD</b>	<b>Sheep</b>	<b>III</b>	<b>Gina McDonnel</b>	<b>(9)</b>
------------	--------------	------------	----------------------	------------

- 1) 1302 - Davenport / Tori ( Aust Kelp)
- 2) 1304 - Wright / Isis ( BC)
- 3) 1308 - Frost / Carma ( Rott)
- 4) 1314 - Godfrey / Singer ( GSD)
- 5) 1315 - Doyle / Jillian ( Aussie)
- 6) 1322 - Madamba / Boomer ( Aust Kelp)
- 7) 1323 - Burnett / Maddie ( BC)
- 8) 1317 - Hansen / Motje ( Aust Kelp)
- 9) 1340 - Murray-Gann / Mike ( BC)

<b>HRD</b>	<b>Sheep</b>	<b>II</b>	<b>Gina McDonnel</b>	<b>(3)</b>
------------	--------------	-----------	----------------------	------------

- 1) 1203 - Wright / McGee ( Aust Kelp)
- 2) 1220 - Garard / Lakota ( ACD)
- 3) 1213 - Bradley / Sugar ( ACD)

# 2014 Kelpie Round-Up

## Class Schedule and Run Order

Check-in starting @ 0630. General Meeting @ 0700. HRD walk-thru at 0715. Lunch break at 1200 and/or between classes. Test classes will follow lunch regardless of where we are in the schedule.

**Saturday, July 19, 2014**

### Judging Group B

Course	Stock	Class	Judge	Entry Cnt
<b>HRD</b>	<b>Sheep</b>	<b>I</b>	<b>Gina McDonnel</b>	<b>(1)</b>
1) 1133 - Davenport / Rooster ( Aust Kelp)				
<b>JHD</b>	<b>Sheep</b>	<b>JHD</b>	<b>Gina McDonnel</b>	<b>(3)</b>
1) 126 - Turner / Fry ( BC)				
2) 136 - Garard / Nikita ( ACD)				
3) 137 - Bell / Tandie ( ACD)				
<b>HTD</b>	<b>Sheep</b>	<b>III</b>	<b>Gina McDonnel</b>	<b>(5)</b>
1) 3315 - Doyle / Jillian ( Aussie)				
2) 3314 - Godfrey / Singer ( GSD)				
3) 3319 - Larson / Denali ( Aust Kelp)				
4) 3327 - MacDonald / Laddie ( BC)				
5) 3304 - Wright / Isis ( BC)				
<b>HTD</b>	<b>Sheep</b>	<b>II</b>	<b>Gina McDonnel</b>	<b>(1)</b>
1) 3222 - Madamba / Boomer ( Aust Kelp)				
<b>HTD</b>	<b>Sheep</b>	<b>I</b>	<b>Gina McDonnel</b>	<b>(2)</b>
1) 3113 - Bradley / Sugar ( ACD)				
2) 3103 - Wright / McGee ( Aust Kelp)				
<b>HTD</b>	<b>Ducks</b>	<b>III</b>	<b>Gina McDonnel</b>	<b>(2)</b>
1) 4309 - Kelly / Kate ( BC)				
2) 4319 - Larson / Denali ( Aust Kelp)				
<b>HTD</b>	<b>Ducks</b>	<b>I</b>	<b>Gina McDonnel</b>	<b>(2)</b>
1) 4113 - Bradley / Sugar ( ACD)				
2) 4133 - Davenport / Rooster ( Aust Kelp)				

# 2014 Kelpie Round-Up

7/27/2014

## PackLeader Farm

Saturday, July 19, 2014

AHBA

Event# 2014KelpieB

HRD III Cattle Judge: Terry Kenney

1/97/H      **2305 Louie (Louie)**  
 AKC PAL252125, DOB: 2/9/2009, Border Collie, Sex: M, Breeder: Alicia Ward Sire: Hapenny Kingfisher Dam: Bree  
 Owner(s): Jen Rice, 6215 47th Ave S, Seattle WA 98118

4/88.5      **2311 WZ I've Got A Secret (Bindi)**  
 AHBA AHBA090054, DOB: 4/6/2008, Australian Cattle Dog, Sex: F, Breeder: Diane Pagel Sire: Carlos Dam: Lucy  
 Owner(s): Killashandra Murray-Gann, Kelly Gann 2006 304th Street South, Roy WA 98580 Handler: Kelly Gann

NQ      **2319 HTCH HighCountry Denali HRDIII HTADIII HTDIII RLFIII HTDIII (Denali)**  
 WKCA A3M 17098 08, DOB: 11/15/2008, Australian Kelpie, Sex: M, Breeder: Susan Crocker Sire: Chuckanut Feng  
 Shui Dam: Marionvale Rani Owner(s): David Larson, Karyl Hansen 380 S. Military Rd., Winlock WA 98596

3/89.5      **2310 Aquila's Forbidden Kosciuszko (Koz)**  
 AKC DN19393202, DOB: 3/29/2007, Australian Cattle Dog, Sex: F, Breeder: Jane Ward Sire: Ch Reddenblu's the  
 Forbidder Dam: Ch Austlyn's Silver'n Jade Owner(s): Paul Murray, 2006 304th Street South, Roy WA 08580

2/93      **2301 HTCH High Country Tempest HRDIII RLFIII HTDIII HTADIII (Tempe)**  
 WKCA A3F-17095, DOB: 11/15/2008, Australian Kelpie, Sex: F, Breeder: Susan Crocker Sire: Chuckanut's Feng  
 Shui Dam: Marionvale Rani Owner(s): Barbara Davenport, 14401 Crews Rd KPN, Gig Harbor WA 98329

HRD II Cattle Judge: Terry Kenney

1/82.5      **2218 Allspice's Betting on Red (Red)**  
 ASCA E166287, DOB: 2/19/2009, Australian Shepherd, Sex: M, Breeder: Dorilee Shobert Sire: WTCH Gambler's  
 Sun Twisp Dam: WTCH Westwinds Spicey Woman Owner(s): Dorilee Shobert, PO Box 1220, Port Orchard WA 98366

HRD I Cattle Judge: Terry Kenney

3/89      **2102 Marionvale Tori HRDII HTADII HTDII RLFII (Tori)**  
 WKCA A3F-18308-09MRV(A19), DOB: 11/20/2009, Australian Kelpie, Sex: F, Breeder: Simon Leaning Sire:  
 Marionvale Alby Dam: Marionvale Rose Owner(s): Barbara Davenport, 14401 Crews Rd KPN, Gig Harbor WA 98329

82      **2113 That'l Du's Sweet New Moon (Sugar)**  
 AKC DN24656702, DOB: 4/2/2009, Australian Cattle Dog, Sex: F, Breeder: Linda Bell Sire: Ray's Blue Bandit  
 Ralph Dam: CH Austlyn's Thatldu's Hi Voltage Owner(s): Kent Bradley, 12615 S Salnave Road, Medical Lake WA  
 99022

2/89      **2103 CLK Oakley HRDI HTADId HTDId (McGee)**  
 NAAKR K04407, DOB: 12/15/2009, Australian Kelpie, Sex: M, Breeder: Kelly Orr Sire: CLK Buckle Dam: CLK Chi  
 Chi Owner(s): Ashley Wright, 2605 North Winnifred Rd., Tacoma WA 98407

83.5      **2106 The Bean (Bean)**  
 AKC PAL201058, DOB: 10/25/2005, Australian Cattle Dog, Sex: F, Breeder: unknown Sire: unknown Dam:  
 Charlotte Owner(s): Jen Rice, 6215 47th Ave S, Seattle WA 98118

83      **2122 DeHaro's Boomerang JHDs HRDI HRDII HTADII HTDII (Boomer)**  
 WKCA S3M-3857 NIL(S4), DOB: 3/30/2011, Australian Kelpie, Sex: M, Breeder: Rick Pinney Sire: Santolina Sam  
 Dam: DeHaro's Nell Owner(s): Shari Madamba, 7323 66th Dr. NE, Marysville WA 98270

67      **2120 Bar H Pistol Packing Lakota Cowgirl (Lakota)**  
 AKC DN27651404, DOB: 4/3/2010, Australian Cattle Dog, Sex: F, Breeder: Lisa & Jesse Hampton Sire: Ch. Jabaluk  
 Cattle Buck Dam: Ch Castle Butte Bindi RA HSAS NA OAJ Owner(s): Shawna Garard, 28811 SE Hwy 224, Eagle Cree  
 OR 97022

1/89.5      **2104 Chesta's Isis of Callaway HRDI HRDII HTADId HTADII HTDII RLFIII (Isis)**  
 AKC PAL257146, DOB: 10/19/2009, Border Collie, Sex: F, Breeder: Unknown Sire: Unknown Dam: Unknown  
 Owner(s): Ashley Wright, 2605 North Winnifred Rd., Tacoma WA 98407

# 2014 Kelpie Round-Up

7/27/2014

## PackLeader Farm

Saturday, July 19, 2014

AHBA

Event# 2014KelpieB

HRD I Cattle Judge: Terry Kenney

**85** **2133 CLK Rooster JHD HTDIs HTADIs (Rooster)**  
 NAAKR K04409, DOB: 1/2/2010, Australian Kelpie, Sex: M, Breeder: Kellp Orr Sire: Moo Hollow Twisp Dam: CLK  
 Cooi Owner(s): Stephen Weigley, 14401 Crews Rd. KPN, Gig Harbor WA 98329 Handler: Barbara Davenport

**4/87** **2108 Frost-King Carma HRDIIs HTADIsd HTDId RLFIs HRDIc HTADIIIs (Carma)**  
 AKC WS35129405, DOB: 7/19/2010, Rottweiler, Sex: F, Breeder: Pamela Frost Sire: BISS CH Pepperhaus  
 Praetorian CD Dam: Frost-King Bewitched HRDIIs HTADId HSAdsc Owner(s): Pamela Frost, 23110 NE Chelatchie Rd,  
 Amboy WA 98601

JHD JHD Sheep Judge: Terry Kenney

**Q** **426 Do You Want Fries With That (Fry)**  
 AKC PAL260625, DOB: 3/1/2012, Border Collie, Sex: M, Breeder: Unknown Sire: Unknown Dam: Unknown Owner(s):  
 Madelyn Turner, 3530 SE 160th, Portland WA 97236

**Q** **438 Silverpark's Sullys Run Freya (Freya)**  
 CKC AL517684, DOB: 6/25/2013, Australian Stumpy Tail Cattle Dog, Sex: F, Breeder: Grace Harper & Thomas  
 McManus Sire: Silverparks Yawanna Bet Dam: Silverparks Blue Cobietta Owner(s): Jen Rice, 6215 47th Ave S, Seattl  
 WA 98118

HTAD3 III Ducks Judge: Terry Kenney

**2/84** **6314 Alta Tollhaus Just a Singer (Singer)**  
 AKC DN26948001, DOB: 12/24/2009, German Shepherd Dog, Sex: M, Breeder: Julie Richards-Mostosky Sire: X Bo  
 Dei Precision Dam: Faye Vom Kinschental Owner(s): Richard Godfrey, Janis Godfrey 4172 Black Mountain Rd, La Mesa  
 CA 91941

**3/76** **6306 The Bean (Bean)**  
 AKC PAL201058, DOB: 10/25/2005, Australian Cattle Dog, Sex: F, Breeder: unknown Sire: unknown Dam:  
 Charlotte Owner(s): Jen Rice, 6215 47th Ave S, Seattle WA 98118

**1/86** **6304 Chesta's Isis of Callaway HRDIIs HRDIIs HTADId HTADIIIs HTDIs RLFIIIs (Isis)**  
 AKC PAL257146, DOB: 10/19/2009, Border Collie, Sex: F, Breeder: Unknown Sire: Unknown Dam: Unknown  
 Owner(s): Ashley Wright, 2605 North Winnifred Rd., Tacoma WA 98407

HTAD3 II Ducks Judge: Terry Kenney

**NQ** **6208 Frost-King Carma HRDIIs HTADIsd HTDId RLFIs HRDIc HTADIIIs (Carma)**  
 AKC WS35129405, DOB: 7/19/2010, Rottweiler, Sex: F, Breeder: Pamela Frost Sire: BISS CH Pepperhaus  
 Praetorian CD Dam: Frost-King Bewitched HRDIIs HTADId HSAdsc Owner(s): Pamela Frost, 23110 NE Chelatchie Rd,  
 Amboy WA 98601

HTAD3 I Ducks Judge: Terry Kenney

**NQ** **6113 That'l Du's Sweet New Moon (Sugar)**  
 AKC DN24656702, DOB: 4/2/2009, Australian Cattle Dog, Sex: F, Breeder: Linda Bell Sire: Ray's Blue Bandit  
 Ralph Dam: CH Austlyn's Thatldu's Hi Voltage Owner(s): Kent Bradley, 12615 S Salnave Road, Medical Lake WA  
 99022

**1/85** **6133 CLK Rooster JHD HTDIs HTADIs (Rooster)**  
 NAAKR K04409, DOB: 1/2/2010, Australian Kelpie, Sex: M, Breeder: Kellp Orr Sire: Moo Hollow Twisp Dam: CLK  
 Cooi Owner(s): Stephen Weigley, 14401 Crews Rd. KPN, Gig Harbor WA 98329 Handler: Barbara Davenport

## 2014 Kelpie Round-Up

7/27/2014

## PackLeader Farm

Saturday, July 19, 2014

AHBA

Event# 2014KelpieB

HTAD4 III Sheep Judge: Terry Kenney

- 3/91** **5309 Kate (Kate)**  
 ASCA T6208, DOB: 3/20/2010, Border Collie, Sex: F, Breeder: Unknown Sire: Unknown Dam: Unknown Owner(s): Kelly L. Kelly, 15113 61st St E, Sumner WA 98390
- 85.5** **5314 Alta Tollhaus Just a Singer (Singer)**  
 AKC DN26948001, DOB: 12/24/2009, German Shepherd Dog, Sex: M, Breeder: Julie Richards-Mostosky Sire: X Bo Dei Precision Dam: Faye Vom Kinschental Owner(s): Richard Godfrey, Janis Godfrey 4172 Black Mountain Rd, La Mesa CA 91941
- 4/90** **5308 Frost-King Carma HRDIIs HTADId HTDId RLFIs HRDIc HTADIIIIs (Carma)**  
 AKC WS35129405, DOB: 7/19/2010, Rottweiler, Sex: F, Breeder: Pamela Frost Sire: BISS CH Pepperhaus Praetorian CD Dam: Frost-King Bewitched HRDI HTADId HSAdsc Owner(s): Pamela Frost, 23110 NE Chelatchie Rd, Amboy WA 98601
- 86** **5306 The Bean (Bean)**  
 AKC PAL201058, DOB: 10/25/2005, Australian Cattle Dog, Sex: F, Breeder: unknown Sire: unknown Dam: Charlotte Owner(s): Jen Rice, 6215 47th Ave S, Seattle WA 98118
- 82.5** **5319 HTCH HighCountry Denali HRDIIs HTADIIIIs HTDIIIIs RLFIIIIs HTDIIIId (Denali)**  
 WKCA A3M 17098 08, DOB: 11/15/2008, Australian Kelpie, Sex: M, Breeder: Susan Crocker Sire: Chuckanut Feng Shui Dam: Marionvale Rani Owner(s): David Larson, Karyl Hansen 380 S. Military Rd., Winlock WA 98596
- 2/92.5** **5304 Chesta's Isis of Callaway HRDIIs HRDIIs HTADId HTADIIIs HTDIIs RLFIIIIs (Isis)**  
 AKC PAL257146, DOB: 10/19/2009, Border Collie, Sex: F, Breeder: Unknown Sire: Unknown Dam: Unknown Owner(s): Ashley Wright, 2605 North Winnifred Rd., Tacoma WA 98407
- 1/93.5/R** **5334 Frost-King Cosmo HRDIIs HTDIIIId RLFIs HTADIIIId (Cosmo)**  
 AKC WS35129401, DOB: 7/19/2010, Rottweiler, Sex: M, Breeder: Pamela Frost Sire: BISS CH Pepperhaus Praetorian CD Dam: Frost-King Bewitched HRDI HTADId HSAdsc JHD Owner(s): Pamela Frost, Art King 23110 NE Chelatchie Rd, Amboy WA 98601
- 81.5** **5311 WZ I've Got A Secret (Bindi)**  
 AHBA AHBA090054, DOB: 4/6/2008, Australian Cattle Dog, Sex: F, Breeder: Diane Pagel Sire: Carlos Dam: Lucy Owner(s): Killashandra Murray-Gann, Kelly Gann 2006 304th Street South, Roy WA 98580

HTAD4 II Sheep Judge: Terry Kenney

- 3/73.5** **5213 That'l Du's Sweet New Moon (Sugar)**  
 AKC DN24656702, DOB: 4/2/2009, Australian Cattle Dog, Sex: F, Breeder: Linda Bell Sire: Ray's Blue Bandit Ralph Dam: CH Austlyn's Thatldu's Hi Voltage Owner(s): Kent Bradley, 12615 S Salnave Road, Medical Lake WA 99022
- 4/68** **5220 Bar H Pistol Packing Lakota Cowgirl (Lakota)**  
 AKC DN27651404, DOB: 4/3/2010, Australian Cattle Dog, Sex: F, Breeder: Lisa & Jesse Hampton Sire: Ch. Jabaluk Cattle Buck Dam: Ch Castle Butte Bindi RA HSAS NA OAJ Owner(s): Shawna Garard, 28811 SE Hwy 224, Eagle Creel OR 97022
- 1/84.5** **5222 DeHaro's Boomerang JHDs HRDIIs HRDIIs HTADIs HTDIIs (Boomer)**  
 WKCA S3M-3857 NIL(S4), DOB: 3/30/2011, Australian Kelpie, Sex: M, Breeder: Rick Pinney Sire: Santolina Sam Dam: DeHaro's Nell Owner(s): Shari Madamba, 7323 66th Dr. NE, Marysville WA 98270
- 2/82** **5203 CLK Oakley HRDIIs HTADId HTDId (McGee)**  
 NAAKR K04407, DOB: 12/15/2009, Australian Kelpie, Sex: M, Breeder: Kelly Orr Sire: CLK Buckle Dam: CLK Chi Chi Owner(s): Ashley Wright, 2605 North Winnifred Rd., Tacoma WA 98407



## 2014 Kelpie Round-Up

7/27/2014

## PackLeader Farm

Saturday, July 19, 2014

AHBA

Event# 2014KelpieB

HTAD4 I Sheep Judge: Terry Kenney

1/77.5 5107 Austlyn Cimarron Nigel P Sullivan (Sully)

AKC DN13750404, DOB: 1/25/2006, Australian Cattle Dog, Sex: M, Breeder: Lynda Rocksvold, Laura Steward Sire: Ch Shalimar's Smoke Jumper CD Dam: CH Get Go's Austlynn Peaches N Cream PT Owner(s): Jen Rice, 6215 47th Ave S, Seattle WA 98118

2/75 5139 Double V Blackbriar JHD (Briar)

ASCA E176559, DOB: 10/17/2011, Australian Shepherd, Sex: M, Breeder: Trudy Viklund Sire: PCH WTCH Chuckanut's Royal Secret PATDCS, CDX Dam: WTCH Kes" Tickin" Man Power Owner(s): Kelly Gann, Trudy Viklund 2006 304th Street South, Roy WA 98580

HRD III Sheep Judge: Gina McDonnel

77 1302 Marionvale Tori HRDIIs HTADIs HTDIsd RLFI (Tori)

WKCA A3F-18308-09MRV(A19), DOB: 11/20/2009, Australian Kelpie, Sex: F, Breeder: Simon Leaning Sire: Marionvale Alby Dam: Marionvale Rose Owner(s): Barbara Davenport, 14401 Crews Rd KPN, Gig Harbor WA 98329

NQ/58 1304 Chesta's Isis of Callaway HRDIIs HRDIIs HTADId HTADIIIs HTDIIs RLFIIIs (Isis)

AKC PAL257146, DOB: 10/19/2009, Border Collie, Sex: F, Breeder: Unknown Sire: Unknown Dam: Unknown Owner(s): Ashley Wright, 2605 North Winnifred Rd., Tacoma WA 98407

NQ/62 1308 Frost-King Carma HRDIIs HTADIsd HTDIId RLFIc HRDIc HTADIIIs (Carma)

AKC WS35129405, DOB: 7/19/2010, Rottweiler, Sex: F, Breeder: Pamela Frost Sire: BISS CH Pepperhaus Praetorian CD Dam: Frost-King Bewitched HRDIIs HTADId HSAdsc Owner(s): Pamela Frost, 23110 NE Chelatchie Rd, Amboy WA 98601

2/82 1314 Alta Tollhaus Just a Singer (Singer)

AKC DN26948001, DOB: 12/24/2009, German Shepherd Dog, Sex: M, Breeder: Julie Richards-Mostosky Sire: X Bo Dei Precision Dam: Faye Vom Kinschental Owner(s): Richard Godfrey, Janis Godfrey 4172 Black Mountain Rd, La Mesa CA 91941

1/87 1315 Legends I Hope You Dance (Jillian)

ASCA E172422, DOB: 1/6/2011, Australian Shepherd, Sex: F, Breeder: Anne and Steve Shope Sire: Graingers Everredy Legends Edi Dam: Legends Starn Say Gnite Gracie Owner(s): Raenell Doyle, P.O. Box 517, Yelm WA 98597

NQ/56 1322 DeHaro's Boomerang JHDs HRDIIs HRDIIs HTADIs HTDIIs (Boomer)

WKCA S3M-3857 NIL(S4), DOB: 3/30/2011, Australian Kelpie, Sex: M, Breeder: Rick Pinney Sire: Santolina Sam Dam: DeHaro's Nell Owner(s): Shari Madamba, 7323 66th Dr. NE, Marysville WA 98270

4/78.5 1323 HTCH Miss Madison Rae (Maddie)

ABCA 0388175, DOB: 1/19/2009, Border Collie, Sex: F, Breeder: Daven & Danielle Wolf Sire: White Diamond Pete Dam: Floss Owner(s): Adrienne Burnett, 15113 61st St E, Sumner WA 98390

NQ/64.5 1317 Marionvale Motje (Motje)

WKCA A3M1507407, DOB: 2/13/2007, Australian Kelpie, Sex: M, Breeder: Simon Leaning Sire: Fleetfeet Axle Dam: Marionvale Rose Owner(s): Karyl Hansen, 380 S. Military Rd., Winlock WA 98596

3/81.5 1340 Mike (Mike)

ABCA 345477, DOB: 10/13/2009, Border Collie, Sex: M, Breeder: Francis Chai Sire: Luke Dam: Chirp Owner(s): Kylo Murray-Gann, 2006 304th Street South, Roy WA 98580

HRD II Sheep Judge: Gina McDonnel

1/67 1203 CLK Oakley HRDIIs HTADIsd HTDIId (McGee)

NAAKR K04407, DOB: 12/15/2009, Australian Kelpie, Sex: M, Breeder: Kelly Orr Sire: CLK Buckle Dam: CLK Chi Chi Owner(s): Ashley Wright, 2605 North Winnifred Rd., Tacoma WA 98407

# 2014 Kelpie Round-Up

7/27/2014

## PackLeader Farm

Saturday, July 19, 2014

AHBA

Event# 2014KelpieB

HRD II Sheep Judge: Gina McDonnel

2/NQ/45 1220 Bar H Pistol Packing Lakota Cowgirl (Lakota)  
AKC DN27651404, DOB: 4/3/2010, Australian Cattle Dog, Sex: F, Breeder: Lisa & Jesse Hampton Sire: Ch. Jabaluk Cattle Buck Dam: Ch Castle Butte Bindi RA HSAS NA OAJ Owner(s): Shawna Garard, 28811 SE Hwy 224, Eagle Creech OR 97022

3/NQ/39.5 1213 That'I Du's Sweet New Moon (Sugar)  
AKC DN24656702, DOB: 4/2/2009, Australian Cattle Dog, Sex: F, Breeder: Linda Bell Sire: Ray's Blue Bandit Ralph Dam: CH Austlyn's ThatIdu's Hi Voltage Owner(s): Kent Bradley, 12615 S Salnave Road, Medical Lake WA 99022

HRD I Sheep Judge: Gina McDonnel

1/69 1133 CLK Rooster JHD HTDIIs HTADIIs (Rooster)  
NAAKR K04409, DOB: 1/2/2010, Australian Kelpie, Sex: M, Breeder: Kellp Orr Sire: Moo Hollow Twisp Dam: CLK Cooi Owner(s): Stephen Weigley, 14401 Crews Rd. KPN, Gig Harbor WA 98329 Handler: Barbara Davenport

JHD JHD Sheep Judge: Gina McDonnel

Q 126 Do You Want Fries With That (Fry)  
AKC PAL260625, DOB: 3/1/2012, Border Collie, Sex: M, Breeder: Unknown Sire: Unknown Dam: Unknown Owner(s): Madelyn Turner, 3530 SE 160th, Portland WA 97236

Q 136 Hillhaven Nikita Gun Powder and Lace (Nikita)  
AKC DN37513003, DOB: 7/25/2013, Australian Cattle Dog, Sex: F, Breeder: Louanne, James, and Amelia Brooks Sire: GCH CH Hillhaven Journey The Rapids HSADs Dam: CH Hillhaven Viva La Vie Owner(s): Shawna Garard, 28811 SE Hwy 224, Eagle Creek OR 97022

Q 137 Austlyn's Thisaway Thataway (Tandie)  
CKC 1124566, DOB: 6/9/2013, Australian Cattle Dog, Sex: F, Breeder: Lynda Rockvold Sire: Can/Am CH Aquila's Ready Aim Fire HTs PTs Dam: Austlyn's Lifes a Song Owner(s): Marilyn Bell, 3762 Sooke Road, Victoria BC V9C4B8

HTD III Sheep Judge: Gina McDonnel

2/81 3315 Legends I Hope You Dance (Jillian)  
ASCA E172422, DOB: 1/6/2011, Australian Shepherd, Sex: F, Breeder: Anne and Steve Shope Sire: Graingers Everredy Legends Edi Dam: Legends Starn Say Gnite Gracie Owner(s): Raenell Doyle, P.O. Box 517, Yelm WA 98597

4/NQ/64.5 3314 Alta Tollhaus Just a Singer (Singer)  
AKC DN26948001, DOB: 12/24/2009, German Shepherd Dog, Sex: M, Breeder: Julie Richards-Mostosky Sire: X Bo Dei Precision Dam: Faye Vom Kinschental Owner(s): Richard Godfrey, Janis Godfrey 4172 Black Mountain Rd, La Mesa CA 91941

1/84.5 3319 HTCH HighCountry Denali HRDIIIs HTADIIIs HTDIIIs RLFIIIs HTDIIId (Denali)  
WKCA A3M 17098 08, DOB: 11/15/2008, Australian Kelpie, Sex: M, Breeder: Susan Crocker Sire: Chuckanut Feng Shui Dam: Marionvale Rani Owner(s): David Larson, Karyl Hansen 380 S. Military Rd., Winlock WA 98596

3/78.5 3327 Laddie (Laddie)  
ABCA 382248, DOB: 8/15/2012, Border Collie, Sex: M, Breeder: Sue McDonald Sire: Nap Dam: Deltablz Jackie Owner(s): Susan Risner, PO Box 86, Port Orchard WA 98366 Handler: Sue MacDonald

NQ 3304 Chesta's Isis of Callaway HRDIIs HRDIIIs HTADId HTADIIIs HTDIIs RLFIIIs (Isis)  
AKC PAL257146, DOB: 10/19/2009, Border Collie, Sex: F, Breeder: Unknown Sire: Unknown Dam: Unknown Owner(s): Ashley Wright, 2605 North Winnifred Rd., Tacoma WA 98407

## 2014 Kelpie Round-Up

7/27/2014

## PackLeader Farm

Saturday, July 19, 2014

AHBA

Event# 2014KelpieB

HTD II Sheep Judge: Gina McDonnel

1/83.5 3222 DeHaro's Boomerang JHDs HRDIs HRDIIs HTADIs HTDIs (Boomer)WKCA S3M-3857 NIL(S4), DOB: 3/30/2011, Australian Kelpie, Sex: M, Breeder: Rick Pinney Sire: Santolina Sam  
Dam: DeHaro's Nell Owner(s): Shari Madamba, 7323 66th Dr. NE, Marysville WA 98270

HTD I Sheep Judge: Gina McDonnel

NQ 3113 That'I Du's Sweet New Moon (Sugar)AKC DN24656702, DOB: 4/2/2009, Australian Cattle Dog, Sex: F, Breeder: Linda Bell Sire: Ray's Blue Bandit  
Ralph Dam: CH Austlyn's Thatldu's Hi Voltage Owner(s): Kent Bradley, 12615 S Salnave Road, Medical Lake WA  
990221/77 3103 CLK Oakley HRDIs HTADIsd HTDIId (McGee)NAAKR K04407, DOB: 12/15/2009, Australian Kelpie, Sex: M, Breeder: Kelly Orr Sire: CLK Buckle Dam: CLK Chi  
Chi Owner(s): Ashley Wright, 2605 North Winnifred Rd., Tacoma WA 98407

HTD III Ducks Judge: Gina McDonnel

2/81 4309 Kate (Kate)ASCA T6208, DOB: 3/20/2010, Border Collie, Sex: F, Breeder: Unknown Sire: Unknown Dam: Unknown Owner(s):  
Kelly L. Kelly, 15113 61st St E, Sumner WA 983901/86 4319 HTCH HighCountry Denali HRDIIs HTADIIIs HTDIIIs RLFIIIs HTDIIId (Denali)WKCA A3M 17098 08, DOB: 11/15/2008, Australian Kelpie, Sex: M, Breeder: Susan Crocker Sire: Chuckanut Feng  
Shui Dam: Marionvale Rani Owner(s): David Larson, Karyl Hansen 380 S. Military Rd., Winlock WA 98596

HTD I Ducks Judge: Gina McDonnel

2/73 4113 That'I Du's Sweet New Moon (Sugar)AKC DN24656702, DOB: 4/2/2009, Australian Cattle Dog, Sex: F, Breeder: Linda Bell Sire: Ray's Blue Bandit  
Ralph Dam: CH Austlyn's Thatldu's Hi Voltage Owner(s): Kent Bradley, 12615 S Salnave Road, Medical Lake WA  
990221/84 4133 CLK Rooster JHD HTDIs HTADIs (Rooster)NAAKR K04409, DOB: 1/2/2010, Australian Kelpie, Sex: M, Breeder: Kellp Orr Sire: Moo Hollow Twisp Dam: CLK  
Cooi Owner(s): Stephen Weigley, 14401 Crews Rd. KPN, Gig Harbor WA 98329 Handler: Barbara Davenport

## Trial Awards - Event 2014KelpieB

HIT : 97.0 Louie (Louie)

2305 Course HRD III Cattle

RHIT: 93.5 Frost-King Cosmo (Cosmo)

5334 Course HTAD4 III Sheep

## JULY 19<sup>th</sup>, 2014 – SHEEP Course #2

### GENERAL RULES:

- Time 20 minutes.
- In all elements, quiet efficient stock work is essential.
- Ties are broken based on individual scores in the following order: Exercise 1 “Sort”, Exercise 7 “Re-pen”, Time.

### STARTING SET- UP:

- All gates are closed except the North gate of the C course Pen at the start of each run.
- There will be stock handlers on course during each run to assist with gates.
- 5 sheep in the trailer. A minimum of 5 sheep in the exhaust pen. A minimum of 20 sheep in the Duck Arena

1. **SORT – 10 pts:** Enter Pen #6. Time begins when the Duck Arena gate is opened. Sort off 5 sheep and exit Pen #6. Exercise ends when the gate between Pen #6 and the back field is closed.

**HRDI/II** Sort any 5 sheep

**HRDIII** Sort 3 adult sheep (chain collars) and 2 lambs (no chains).

2. **FETCH/DRIVE – HRDI/II: 20 pts, HRDIII: 25 pts:** Exercise begins when the gate between Pen #6 and the back field is closed. Move sheep in an “S” shape passing West of the marked tree North of the Freestanding Pen and South of the Large Pen, pen the sheep through the North gate. (NOTE: There will be a stock handler in the Large Pen.) Exercise ends when the sheep enter the pen. All sheep must be penned.

**HRDI** Handler may take any position. Handler will close gate after penning sheep.

**HRDII** Handler remains behind the HRDII handler’s line. Stock handler will close gate after #3 HOLD.

**HRDIII** Handler remains behind the HRDIII handler’s line. Stock handler will close gate after #3 HOLD.

3. **HOLD – 10 pts:** Exercise begins when the sheep enter the Large Pen. Dog will remain at the Large Pen North gate until recalled by the handler. Exercise ends when dog reaches handler.

**HRDI** Dog will remain at the closed pen gate until the handler reaches HTD Obstacle #2

**HRDII** Dog will remain at the open pen gate until the handler reaches HTD Obstacle #2

**HRDIII** Dog will remain at the open pen gate until the handler reaches the Chute

4. **TRAILER – HRDI/II: 10 pts, HRDIII: 15 pts:** Exercise begins when dog reaches the handler. Remove sheep from trailer. Exercise ends when the sheep exit the trailer from the correct door.

**HRDI/II** Handler may remove the sheep from the Trailer or enter the Trailer to assist the dog

**HRDIII** Handler opens the back door. Dog will hold the sheep while the handler opens the side door. Dog will bring the sheep out the side door of the trailer.

5. **EXHAUST – 10 pts:** Exercise begins when the sheep exit the trailer from the correct door. Move sheep toward Pen #6. Call dog off before dog enters pen. (NOTE: Gate to Pen # 6 will be standing open, a stock handler will close gate.) Exercise ends when all sheep are penned and dog has successfully called off.

6. **GATHER – 20 pts:** Exercise begins when all sheep are penned and dog has successfully called off. Send dog to gather sheep from Large Pen and fetch to handler. NOTE: Stock handler will open gate(s) when dog is sent. Exercise ends when the sheep pass HTD Obstacle #2.

**HRDI** Both gates are open. Dog is left at or started from behind the HRDII handler’s line. Handler may move anywhere outside Large Pen.

**HRDII** Both gates are open. Dog is left at or started from anywhere behind the HRDIII handler’s line. Handler remains behind the HRDII handler’s line.

**HRDIII** North gate is open. Dog is started from anywhere behind the HRDIII handler’s line. Handler remains behind the HRDIII handler’s line.

7. **RE-PEN – 10 pts:** Exercise begins when the sheep pass the HTD Obstacles. Re-pen sheep thru the back door of the trailer. Exercise/Time ends when the trailer door is closed.



2014 Kelpie Round-Up  
AHBA HRD - SHEEP Course #2

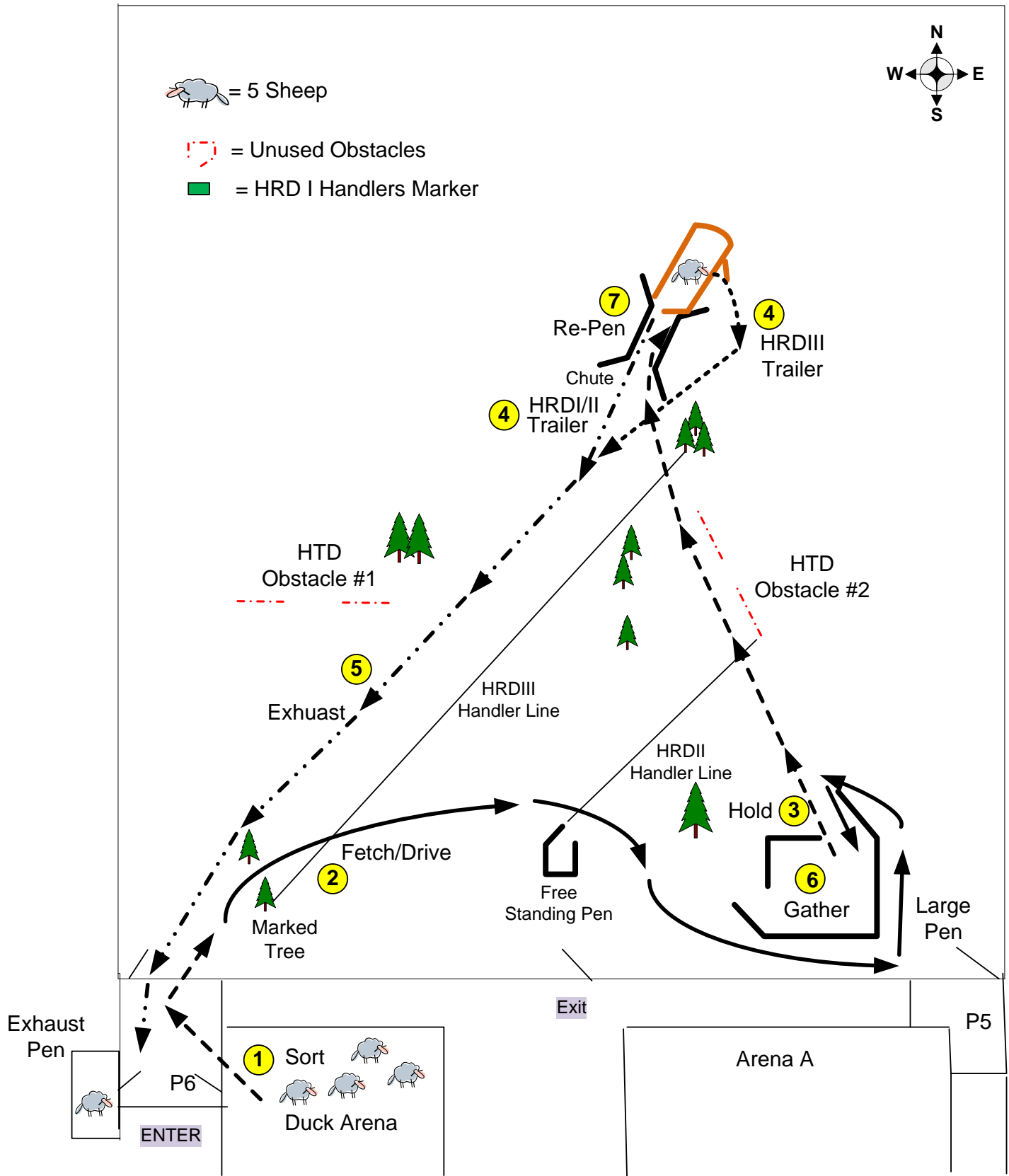

## JULY 19<sup>th</sup>, 2014 – CATTLE Course #1

### GENERAL RULES:

- Time 20 minutes.
- In all elements, quiet efficient stock work is essential.
- All elements must be attempted prior to moving on.
- All gates may be open/closed or pre-set at the Handler's discretion to increase safety.
- Time will not end until all gates have been restored to their original/starting position.
- Ties are broken based on individual scores in the following order: Exercise 8 "Re-Pen", Exercise 1 "Small Pen", Time.

### STARTING SET- UP:

- All gates must be returned to the starting positions.
  - 5 cows in Side Pen A, 5 cows in Side Pen B, 5 cows in Arena B, and 5 cows in reserve resting (stock handler will advance this group in rotation).
1. **SMALL PEN – 10 pts.:** Enter through designated 4' gate. Exercise begins when gate to Side Pen A is opened. Remove (5) cows from Side Pen A, moving them through Pen #2 and into Arena A. Exercise ends when gate to Arena A is closed.
  2. **FETCH/DRIVE – 20 pts.:** Exercise begins when gate to Arena A is closed. HRDI & II - Move the cows from the gate through Obstacle #1, counterclockwise around the Freestanding Pen. HRDIII - Move the cows from the gate through Obstacle #1, counterclockwise around the designated Post and through Obstacle #2. Exercise ends when the cows have cleared the plane of Obstacle #2.
    - **HRDI** Handler may move anywhere
    - **HRDII** Handler remains at Handler's Post until the cows exit Obstacle #1.
    - **HRDIII** Handler remains at the Handler's Post until the cows have passed behind the cone.
  3. **HRDIII ONLY: SORT – 10 pts.:** Exercise begins when the cows have cleared the plane of Obstacle #2. Sort 3 cows into Pen #1 and close gate. Pen remaining cows in Pen #1. Exercise ends when gate between Arena A and Pen#1 is closed.
  4. **STOCKYARD – 10 pts.:** Exercise begins when the Arena A gate is opened. HRDI/II - Move cows from Arena A through stockyard and pen in Pen #4. HRDIII - Combine remaining cows from Arena A with sorted cows and move through stockyard and pen in Pen #4. Exercise ends when Pen #4 gate is closed.
  5. **PASS THROUGH – 10 pts.:** Exercise begins when Pen #4 gate is closed. Pass through Side Pen B, with your dog, without disturbing the cows. Exercise ends when the team is in the Narrow Alley with the gate closed.
  6. **GATHER – 15 pts.:** Exercise begins when the team is in the Narrow Alley with the gate closed. Enter Arena B through Pen #3. Gather (5) cows and proceed to Pen #3. Move cows through Pen #3 and release in Back Alley. Exercise ends when the gate between Pen #3 and Back Alley is closed.
    - **HRDI** Dog is left approximately halfway to cow's position, Handler may move within 15 feet of cows
    - **HRDII** Dog is left at the Handler's Post, Handler may move ½ way.
    - **HRDIII** Team begins at the Handler's Post, where the Handler remains until the dog is sent. Once the dog is sent, the handler may not move forward of the post.
  7. **SIDE PEN B – 10 pts.:** Exercise begins when the gate between Pen#3 and Back Alley is closed. Gather (5) cows from Side Pen B and release into Arena B. Exercise ends when the gate to Arena B is closed.
  8. **RE-PEN - 15 pts.:** Exercise begins when the gate to Arena B is closed. Gather/move cows from Back Alley through Pen #2 and pen in Side Pen A. Exercise ends when the gate to Side Pen A is closed.

Time stops when ALL gates have been restored to their original/starting position.

2014 Kelpie Round-Up  
AHBA HRD – CATTLE Course #1

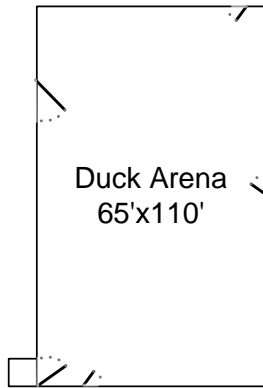

Pen alleyways are 6' wide, all other alleyways are a minimum of 12'.

All stockyard pens are 12' x 12' sq.  
Side Pen Is 18' x 60'

= 5 cows

= Post

= Unused Obstacles

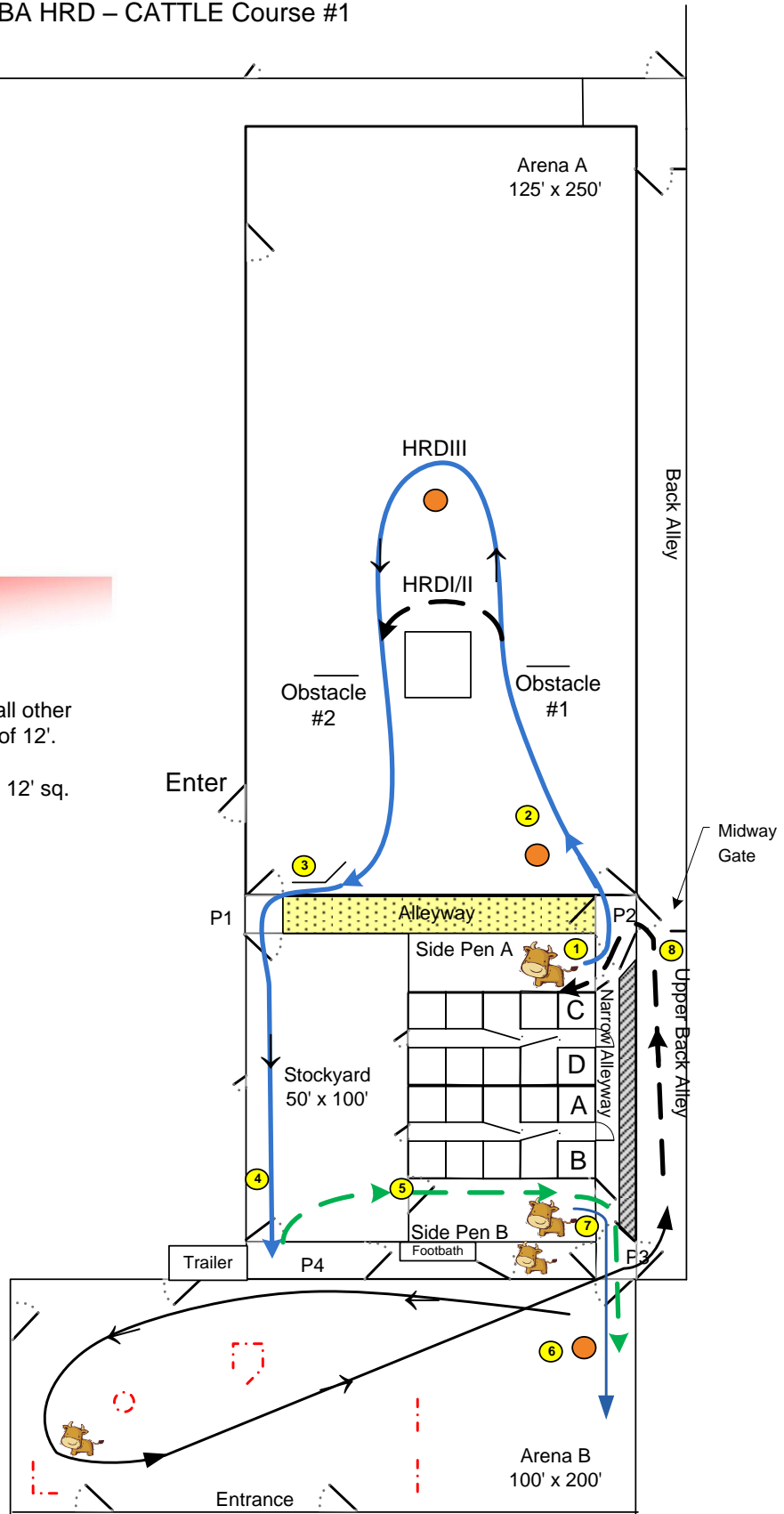

# 2014 Kelpie Round-Up

## Class Schedule and Run Order

Check-in starting @ 0630. General Meeting @ 0700. HRD walk-thru at 0715. Lunch break at 1200 and/or between classes.  
Test classes will follow lunch regardless of where we are in the schedule.

**Sunday, July 20, 2014**

### Judging Group A

Course	Stock	Class	Judge	Entry Cnt
--------	-------	-------	-------	-----------

**Est. Start Time : 7:30 AM**

<b>HRD</b>	<b>Cattle</b>	<b>III</b>	<b>Gina McDonnel</b>	<b>(5)</b>
------------	---------------	------------	----------------------	------------

- 1) 2311 - Gann / Bindi ( ACD)
- 2) 2310 - Murray / Koz ( ACD)
- 3) 2301 - Davenport / Tempe ( Aust Kelp)
- 4) 2319 - Larson / Denali ( Aust Kelp)
- 5) 2305 - Rice / Louie ( BC)

<b>HRD</b>	<b>Cattle</b>	<b>II</b>	<b>Gina McDonnel</b>	<b>(1)</b>
------------	---------------	-----------	----------------------	------------

- 1) 2218 - Shobert / Red ( Aussie)

<b>HRD</b>	<b>Cattle</b>	<b>I</b>	<b>Gina McDonnel</b>	<b>(9)</b>
------------	---------------	----------	----------------------	------------

- 1) 2103 - Wright / McGee ( Aust Kelp)
- 2) 2120 - Garard / Lakota ( ACD)
- 3) 2102 - Davenport / Tori ( Aust Kelp)
- 4) 2122 - Madamba / Boomer ( Aust Kelp)
- 5) 2108 - Frost / Carma ( Rott)
- 6) 2104 - Wright / Isis ( BC)
- 7) 2133 - Davenport / Rooster ( Aust Kelp)
- 8) 2106 - Rice / Bean ( ACD)
- 9) 2134 - Frost / Cosmo ( Rott)

<b>HTAD4</b>	<b>Sheep</b>	<b>III</b>	<b>Gina McDonnel</b>	<b>(9)</b>
--------------	--------------	------------	----------------------	------------

- 1) 5306 - Rice / Bean ( ACD)
- 2) 5314 - Godfrey / Singer ( GSD)
- 3) 5319 - Larson / Denali ( Aust Kelp)
- 4) 5308 - Frost / Carma ( Rott)
- 5) 5315 - Doyle / Jillian ( Aussie)
- 6) 5309 - Kelly / Kate ( BC)
- 7) 5304 - Wright / Isis ( BC)
- 8) 5325 - Watson / Dart ( BC)
- 9) 5334 - Frost / Cosmo ( Rott)

<b>HTAD4</b>	<b>Sheep</b>	<b>II</b>	<b>Gina McDonnel</b>	<b>(3)</b>
--------------	--------------	-----------	----------------------	------------

- 1) 5222 - Madamba / Boomer ( Aust Kelp)
- 2) 5220 - Garard / Lakota ( ACD)
- 3) 5203 - Wright / McGee ( Aust Kelp)

**Sunday, July 20, 2014**

### Judging Group A

Course	Stock	Class	Judge	Entry Cnt
--------	-------	-------	-------	-----------

<b>HTAD4</b>	<b>Sheep</b>	<b>I</b>	<b>Gina McDonnel</b>	<b>(2)</b>
--------------	--------------	----------	----------------------	------------

- 1) 5107 - Rice / Sully ( ACD)
- 2) 5126 - Turner / Fry ( BC)

### Judging Group B

Course	Stock	Class	Judge	Entry Cnt
--------	-------	-------	-------	-----------

**Est. Start Time : 8:00 AM**

<b>HTD</b>	<b>Sheep</b>	<b>III</b>	<b>Barbara Davenport</b>	<b>(6)</b>
------------	--------------	------------	--------------------------	------------

- 1) 3319 - Larson / Denali ( Aust Kelp)
- 2) 3323 - Burnett / Maddie ( BC)
- 3) 3315 - Doyle / Jillian ( Aussie)
- 4) 3314 - Godfrey / Singer ( GSD)
- 5) 3325 - Watson / Dart ( BC)
- 6) 3304 - Wright / Isis ( BC)

<b>HTD</b>	<b>Sheep</b>	<b>II</b>	<b>Barbara Davenport</b>	<b>(1)</b>
------------	--------------	-----------	--------------------------	------------

- 1) 3222 - Madamba / Boomer ( Aust Kelp)

<b>HTD</b>	<b>Sheep</b>	<b>I</b>	<b>Barbara Davenport</b>	<b>(1)</b>
------------	--------------	----------	--------------------------	------------

- 1) 3103 - Wright / McGee ( Aust Kelp)

<b>HTD</b>	<b>Ducks</b>	<b>III</b>	<b>Barbara Davenport</b>	<b>(2)</b>
------------	--------------	------------	--------------------------	------------

- 1) 4319 - Larson / Denali ( Aust Kelp)
- 2) 4309 - Kelly / Kate ( BC)

### Judging Group C

Course	Stock	Class	Judge	Entry Cnt
--------	-------	-------	-------	-----------

**Est. Start Time : 1:00 PM**

<b>JHD</b>	<b>Sheep</b>	<b>JHD</b>	<b>David Larson</b>	<b>(2)</b>
------------	--------------	------------	---------------------	------------

- 1) 138 - Rice / Freya ( ASTCD)
- 2) 136 - Garard / Nikita ( ACD)

<b>HTD</b>	<b>Sheep</b>	<b>III</b>	<b>David Larson</b>	<b>(1)</b>
------------	--------------	------------	---------------------	------------

- 1) 3402 - Davenport / Tori ( Aust Kelp)

<b>HTD</b>	<b>Ducks</b>	<b>III</b>	<b>David Larson</b>	<b>(1)</b>
------------	--------------	------------	---------------------	------------

- 1) 3502 - Davenport / Tori ( Aust Kelp)



## 2014 Kelpie Round-Up

### Class Schedule and Run Order

---

Check-in starting @ 0630. General Meeting @ 0700. HRD walk-thru at 0715. Lunch break at 1200 and/or between classes.  
 Test classes will follow lunch regardless of where we are in the schedule.

**Sunday, July 20, 2014**

#### Judging Group C

Course	Stock	Class	Judge	Entry Cnt
<b>HTD</b>	<b>Ducks</b>	<b>I</b>	<b>David Larson</b>	<b>(1)</b>
1) 3633 - Weigley / Rooster ( Aust Kelp)				
<b>HTAD3</b>	<b>Ducks</b>	<b>III</b>	<b>David Larson</b>	<b>(2)</b>
1) 6314 - Godfrey / Singer ( GSD)				
2) 6304 - Wright / Isis ( BC)				
<b>HTAD3</b>	<b>Ducks</b>	<b>II</b>	<b>David Larson</b>	<b>(1)</b>
1) 6208 - Frost / Carma ( Rott)				
<b>HTAD3</b>	<b>Ducks</b>	<b>I</b>	<b>David Larson</b>	<b>(1)</b>
1) 6133 - Davenport / Rooster ( Aust Kelp)				

# 2014 Kelpie Round-Up

7/27/2014

## PackLeader Farm

Sunday, July 20, 2014

AHBA

Event# 2014KelpieC

HRD III Cattle Judge: Gina McDonnel

- 1/88** **2311 WZ I've Got A Secret (Bindi)**  
 AHBA AHBA090054, DOB: 4/6/2008, Australian Cattle Dog, Sex: F, Breeder: Diane Pagel Sire: Carlos Dam: Lucy  
 Owner(s): Killashandra Murray-Gann, Kelly Gann 2006 304th Street South, Roy WA 98580 Handler: Kelly Gann
- 3/83.5** **2310 Aquila's Forbidden Kosciuszko (Koz)**  
 AKC DN19393202, DOB: 3/29/2007, Australian Cattle Dog, Sex: F, Breeder: Jane Ward Sire: Ch Reddenblu's the  
 Forbidder Dam: Ch Austlyn's Silver'n Jade Owner(s): Paul Murray, 2006 304th Street South, Roy WA 08580
- 74** **2301 HTCH High Country Tempest HRDIIIs RLFIIIs HTDIIIsd HTADIIIsd (Tempe)**  
 WKCA A3F-17095, DOB: 11/15/2008, Australian Kelpie, Sex: F, Breeder: Susan Crocker Sire: Chuckanut's Feng  
 Shui Dam: Marionvale Rani Owner(s): Barbara Davenport, 14401 Crews Rd KPN, Gig Harbor WA 98329
- 4/81** **2319 HTCH HighCountry Denali HRDIIIs HTADIIIs HTDIIIs RLFIIIs HTDIIId (Denali)**  
 WKCA A3M 17098 08, DOB: 11/15/2008, Australian Kelpie, Sex: M, Breeder: Susan Crocker Sire: Chuckanut Feng  
 Shui Dam: Marionvale Rani Owner(s): David Larson, Karyl Hansen 380 S. Military Rd., Winlock WA 98596
- 2/83.5** **2305 Louie (Louie)**  
 AKC PAL252125, DOB: 2/9/2009, Border Collie, Sex: M, Breeder: Alicia Ward Sire: Hapenny Kingfisher Dam: Bree  
 Owner(s): Jen Rice, 6215 47th Ave S, Seattle WA 98118

HRD II Cattle Judge: Gina McDonnel

- 1/67** **2218 Allspice's Betting on Red (Red)**  
 ASCA E166287, DOB: 2/19/2009, Australian Shepherd, Sex: M, Breeder: Dorilee Shobert Sire: WTCH Gambler's  
 Sun Twisp Dam: WTCH Westwinds Spicey Woman Owner(s): Dorilee Shobert, PO Box 1220, Port Orchard WA 98366

HRD I Cattle Judge: Gina McDonnel

- NQ/53** **2103 CLK Oakley HRDIs HTADIsd HTDId (McGee)**  
 NAAKR K04407, DOB: 12/15/2009, Australian Kelpie, Sex: M, Breeder: Kelly Orr Sire: CLK Buckle Dam: CLK Chi  
 Chi Owner(s): Ashley Wright, 2605 North Winnifred Rd., Tacoma WA 98407
- NQ/51** **2120 Bar H Pistol Packing Lakota Cowgirl (Lakota)**  
 AKC DN27651404, DOB: 4/3/2010, Australian Cattle Dog, Sex: F, Breeder: Lisa & Jesse Hampton Sire: Ch. Jabaluk  
 Cattle Buck Dam: Ch Castle Butte Bindi RA HSAS NA OAJ Owner(s): Shawna Garard, 28811 SE Hwy 224, Eagle Cree  
 OR 97022
- 73.5** **2102 Marionvale Tori HRDIIIs HTADIs HTDIsd RLFI (Tori)**  
 WKCA A3F-18308-09MRV(A19), DOB: 11/20/2009, Australian Kelpie, Sex: F, Breeder: Simon Leaning Sire:  
 Marionvale Alby Dam: Marionvale Rose Owner(s): Barbara Davenport, 14401 Crews Rd KPN, Gig Harbor WA 98329
- NQ/10.5** **2122 DeHaro's Boomerang JHDs HRDIs HRDIIIs HTADIs HTDIs (Boomer)**  
 WKCA S3M-3857 NIL(S4), DOB: 3/30/2011, Australian Kelpie, Sex: M, Breeder: Rick Pinney Sire: Santolina Sam  
 Dam: DeHaro's Nell Owner(s): Shari Madamba, 7323 66th Dr. NE, Marysville WA 98270
- 3/83** **2108 Frost-King Carma HRDIIIs HTADIsd HTDId RLFIs HRDIc HTADIIIs (Carma)**  
 AKC WS35129405, DOB: 7/19/2010, Rottweiler, Sex: F, Breeder: Pamela Frost Sire: BISS CH Pepperhaus  
 Praetorian CD Dam: Frost-King Bewitched HRDIs HTADId HSAAsc Owner(s): Pamela Frost, 23110 NE Chelatchie Rd,  
 Amboy WA 98601
- 4/77.5** **2104 Chesta's Isis of Callaway HRDIs HRDIIIs HTADId HTADIIIs HTDIs RLFIIIs (Isis)**  
 AKC PAL257146, DOB: 10/19/2009, Border Collie, Sex: F, Breeder: Unknown Sire: Unknown Dam: Unknown  
 Owner(s): Ashley Wright, 2605 North Winnifred Rd., Tacoma WA 98407
- 65** **2133 CLK Rooster JHD HTDIs HTADIs (Rooster)**  
 NAAKR K04409, DOB: 1/2/2010, Australian Kelpie, Sex: M, Breeder: Kellp Orr Sire: Moo Hollow Twisp Dam: CLK  
 Cooi Owner(s): Stephen Weigley, 14401 Crews Rd. KPN, Gig Harbor WA 98329 Handler: Barbara Davenport

## 2014 Kelpie Round-Up

7/27/2014

## PackLeader Farm

Sunday, July 20, 2014

AHBA

Event# 2014KelpieC

HRD I Cattle Judge: Gina McDonnel

2/84.5 2106 The Bean (Bean)

AKC PAL201058, DOB: 10/25/2005, Australian Cattle Dog, Sex: F, Breeder: unknown Sire: unknown Dam: Charlotte Owner(s): Jen Rice, 6215 47th Ave S, Seattle WA 98118

1/86 2134 Frost-King Cosmo HRDIIs HTDIIIId RLFIs HTADIIIId (Cosmo)

AKC WS35129401, DOB: 7/19/2010, Rottweiler, Sex: M, Breeder: Pamela Frost Sire: BISS CH Pepperhaus Praetorian CD Dam: Frost-King Bewitched HRDI HTADId HSAdsc JHD Owner(s): Pamela Frost, Art King 23110 NE Chelatchie Rd, Amboy WA 98601

HTAD4 III Sheep Judge: Gina McDonnel

83.5 5306 The Bean (Bean)

AKC PAL201058, DOB: 10/25/2005, Australian Cattle Dog, Sex: F, Breeder: unknown Sire: unknown Dam: Charlotte Owner(s): Jen Rice, 6215 47th Ave S, Seattle WA 98118

85.5 5314 Alta Tollhaus Just a Singer (Singer)

AKC DN26948001, DOB: 12/24/2009, German Shepherd Dog, Sex: M, Breeder: Julie Richards-Mostosky Sire: X Bo Dei Precision Dam: Faye Vom Kinschental Owner(s): Richard Godfrey, Janis Godfrey 4172 Black Mountain Rd, La Mesa CA 91941

2/92 5319 HTCH HighCountry Denali HRDIIs HTADIIIIs HTDIIIIs RLFIIIIs HTDIIIId (Denali)

WKCA A3M 17098 08, DOB: 11/15/2008, Australian Kelpie, Sex: M, Breeder: Susan Crocker Sire: Chuckanut Feng Shui Dam: Marionvale Rani Owner(s): David Larson, Karyl Hansen 380 S. Military Rd., Winlock WA 98596

79.5 5308 Frost-King Carma HRDIIs HTADId HTDId RLFIs HRDIc HTADIIIIs (Carma)

AKC WS35129405, DOB: 7/19/2010, Rottweiler, Sex: F, Breeder: Pamela Frost Sire: BISS CH Pepperhaus Praetorian CD Dam: Frost-King Bewitched HRDI HTADId HSAdsc Owner(s): Pamela Frost, 23110 NE Chelatchie Rd, Amboy WA 98601

89.5 5315 Legends I Hope You Dance (Jillian)

ASCA E172422, DOB: 1/6/2011, Australian Shepherd, Sex: F, Breeder: Anne and Steve Shope Sire: Graingers Everredy Legends Edi Dam: Legends Starn Say Gnite Gracie Owner(s): Raenell Doyle, P.O. Box 517, Yelm WA 98597

1/95 5309 Kate (Kate)

ASCA T6208, DOB: 3/20/2010, Border Collie, Sex: F, Breeder: Unknown Sire: Unknown Dam: Unknown Owner(s): Kelly L. Kelly, 15113 61st St E, Sumner WA 98390

85.5 5304 Chesta's Isis of Callaway HRDIIs HRDIIs HTADId HTADIIIs HTDIIs RLFIIIIs (Isis)

AKC PAL257146, DOB: 10/19/2009, Border Collie, Sex: F, Breeder: Unknown Sire: Unknown Dam: Unknown Owner(s): Ashley Wright, 2605 North Winnifred Rd., Tacoma WA 98407

4/90 5325 Dart (Dart)

ABCA 381677, DOB: 4/10/2012, Border Collie, Sex: F, Breeder: Billie Estridge Sire: Web Dam: Tess Owner(s): Craig Watson, 171 East Sunset Hill Rd, Shelton WA 98584

3/90.5 5334 Frost-King Cosmo HRDIIs HTDIIIId RLFIs HTADIIIId (Cosmo)

AKC WS35129401, DOB: 7/19/2010, Rottweiler, Sex: M, Breeder: Pamela Frost Sire: BISS CH Pepperhaus Praetorian CD Dam: Frost-King Bewitched HRDI HTADId HSAdsc JHD Owner(s): Pamela Frost, Art King 23110 NE Chelatchie Rd, Amboy WA 98601

HTAD4 II Sheep Judge: Gina McDonnel

2/82.5 5222 DeHaro's Boomerang JHDs HRDIIs HRDIIs HTADIs HTDIIs (Boomer)

WKCA S3M-3857 NIL(S4), DOB: 3/30/2011, Australian Kelpie, Sex: M, Breeder: Rick Pinney Sire: Santolina Sam Dam: DeHaro's Nell Owner(s): Shari Madamba, 7323 66th Dr. NE, Marysville WA 98270

## 2014 Kelpie Round-Up

7/27/2014

## PackLeader Farm

Sunday, July 20, 2014

AHBA

Event# 2014KelpieC

HTAD4 II Sheep Judge: Gina McDonnel

3/68.5 5220 Bar H Pistol Packing Lakota Cowgirl (Lakota)

AKC DN27651404, DOB: 4/3/2010, Australian Cattle Dog, Sex: F, Breeder: Lisa &amp; Jesse Hampton Sire: Ch. Jabaluk Cattle Buck Dam: Ch Castle Butte Bindi RA HSAS NA OAJ Owner(s): Shawna Garard, 28811 SE Hwy 224, Eagle Creek OR 97022

1/85 5203 CLK Oakley HRDI's HTADId HTDI (McGee)

NAAKR K04407, DOB: 12/15/2009, Australian Kelpie, Sex: M, Breeder: Kelly Orr Sire: CLK Buckle Dam: CLK Chi Chi Owner(s): Ashley Wright, 2605 North Winnifred Rd., Tacoma WA 98407

HTAD4 I Sheep Judge: Gina McDonnel

1/80.5 5107 Austlyn Cimarron Nigel P Sullivan (Sully)

AKC DN13750404, DOB: 1/25/2006, Australian Cattle Dog, Sex: M, Breeder: Lynda Rocksvold, Laura Steward Sire: Ch Shalimar's Smoke Jumper CD Dam: CH Get Go's Austlynn Peaches N Cream PT Owner(s): Jen Rice, 6215 47th Ave S, Seattle WA 98118

2/75 5126 Do You Want Fries With That (Fry)

AKC PAL260625, DOB: 3/1/2012, Border Collie, Sex: M, Breeder: Unknown Sire: Unknown Dam: Unknown Owner(s): Madelyn Turner, 3530 SE 160th, Portland WA 97236

HTD III Sheep Judge: Barbara Davenport

3/84.5 3319 HTCH HighCountry Denali HRDIIs HTADIIIs HTDIIIs RLFIIIs HTDIIId (Denali)

WKCA A3M 17098 08, DOB: 11/15/2008, Australian Kelpie, Sex: M, Breeder: Susan Crocker Sire: Chuckanut Feng Shui Dam: Marionvale Rani Owner(s): David Larson, Karyl Hansen 380 S. Military Rd., Winlock WA 98596

1/93.5/R 3323 HTCH Miss Madison Rae (Maddie)

ABCA 0388175, DOB: 1/19/2009, Border Collie, Sex: F, Breeder: Daven &amp; Danielle Wolf Sire: White Diamond Pete Dam: Floss Owner(s): Adrienne Burnett, 15113 61st St E, Sumner WA 98390

82.5 3315 Legends I Hope You Dance (Jillian)

ASCA E172422, DOB: 1/6/2011, Australian Shepherd, Sex: F, Breeder: Anne and Steve Shope Sire: Graingers Everredy Legends Edi Dam: Legends Starn Say Gnite Gracie Owner(s): Raenell Doyle, P.O. Box 517, Yelm WA 98597

4/83 3314 Alta Tollhaus Just a Singer (Singer)

AKC DN26948001, DOB: 12/24/2009, German Shepherd Dog, Sex: M, Breeder: Julie Richards-Mostosky Sire: X Bo Dei Precision Dam: Faye Vom Kinschental Owner(s): Richard Godfrey, Janis Godfrey 4172 Black Mountain Rd, La Mesa CA 91941

2/92 3325 Dart (Dart)

ABCA 381677, DOB: 4/10/2012, Border Collie, Sex: F, Breeder: Billie Estridge Sire: Web Dam: Tess Owner(s): Craig Watson, 171 East Sunset Hill Rd, Shelton WA 98584

77 3304 Chesta's Isis of Callaway HRDI's HRDIIs HTADId HTADII's HTDI's RLFIIIs (Isis)

AKC PAL257146, DOB: 10/19/2009, Border Collie, Sex: F, Breeder: Unknown Sire: Unknown Dam: Unknown Owner(s): Ashley Wright, 2605 North Winnifred Rd., Tacoma WA 98407

HTD II Sheep Judge: Barbara Davenport

1/73 3222 DeHaro's Boomerang JHDs HRDI's HRDIIs HTADIs HTDI's (Boomer)

WKCA S3M-3857 NIL(S4), DOB: 3/30/2011, Australian Kelpie, Sex: M, Breeder: Rick Pinney Sire: Santolina Sam Dam: DeHaro's Nell Owner(s): Shari Madamba, 7323 66th Dr. NE, Marysville WA 98270

## 2014 Kelpie Round-Up

7/27/2014

## PackLeader Farm

Sunday, July 20, 2014

AHBA

Event# 2014KelpieC

HTD I Sheep Judge: Barbara Davenport

1/75.5 3103 CLK Oakley HRDIIs HTADIsd HTDIId (McGee)

NAAKR K04407, DOB: 12/15/2009, Australian Kelpie, Sex: M, Breeder: Kelly Orr Sire: CLK Buckle Dam: CLK Chi Chi Owner(s): Ashley Wright, 2605 North Winnifred Rd., Tacoma WA 98407

HTD III Ducks Judge: Barbara Davenport

2/91 4319 HTCH HighCountry Denali HRDIIIIs HTADIIIIs HTDIIIIs RLFIIIIs HTDIIIId (Denali)

WKCA A3M 17098 08, DOB: 11/15/2008, Australian Kelpie, Sex: M, Breeder: Susan Crocker Sire: Chuckanut Feng Shui Dam: Marionvale Rani Owner(s): David Larson, Karyl Hansen 380 S. Military Rd., Winlock WA 98596

1/96/H 4309 Kate (Kate)

ASCA T6208, DOB: 3/20/2010, Border Collie, Sex: F, Breeder: Unknown Sire: Unknown Dam: Unknown Owner(s): Kelly L. Kelly, 15113 61st St E, Sumner WA 98390

JHD JHD Sheep Judge: David Larson

Q 138 Silverpark's Sullys Run Freya (Freya)

CKC AL517684, DOB: 6/25/2013, Australian Stumpy Tail Cattle Dog, Sex: F, Breeder: Grace Harper &amp; Thomas McManus Sire: Silverparks Yawanna Bet Dam: Silverparks Blue Cobiatta Owner(s): Jen Rice, 6215 47th Ave S, Seattle WA 98118

Q 136 Hillhaven Nikita Gun Powder and Lace (Nikita)

AKC DN37513003, DOB: 7/25/2013, Australian Cattle Dog, Sex: F, Breeder: Louanne, James, and Amelia Brooks Sire: GCH CH Hillhaven Journey The Rapids HSADs Dam: CH Hillhaven Viva La Vie Owner(s): Shawna Garard, 28811 St Hwy 224, Eagle Creek OR 97022

HTD III Sheep Judge: David Larson

1/87 3402 Marionvale Tori HRDIIIs HTADIIs HTDIId RLFI (Tori)

WKCA A3F-18308-09MRV(A19), DOB: 11/20/2009, Australian Kelpie, Sex: F, Breeder: Simon Leaning Sire: Marionvale Alby Dam: Marionvale Rose Owner(s): Barbara Davenport, 14401 Crews Rd KPN, Gig Harbor WA 98329

HTD III Ducks Judge: David Larson

1/91 3502 Marionvale Tori HRDIIIs HTADIIs HTDIId RLFI (Tori)

WKCA A3F-18308-09MRV(A19), DOB: 11/20/2009, Australian Kelpie, Sex: F, Breeder: Simon Leaning Sire: Marionvale Alby Dam: Marionvale Rose Owner(s): Barbara Davenport, 14401 Crews Rd KPN, Gig Harbor WA 98329

HTD I Ducks Judge: David Larson

1/79 3633 CLK Rooster JHD HTDIIs HTADIIs (Rooster)

NAAKR K04409, DOB: 1/2/2010, Australian Kelpie, Sex: M, Breeder: Kelly Orr Sire: Moo Hollow Twisp Dam: CLK Cooi Owner(s): Stephen Weigley, 14401 Crews Rd. KPN, Gig Harbor WA 98329

HTAD3 III Ducks Judge: David Larson

2/NQ/55 6314 Alta Tollhaus Just a Singer (Singer)

AKC DN26948001, DOB: 12/24/2009, German Shepherd Dog, Sex: M, Breeder: Julie Richards-Mostosky Sire: X Bo Dei Precision Dam: Faye Vom Kinschental Owner(s): Richard Godfrey, Janis Godfrey 4172 Black Mountain Rd, La Mesa CA 91941

# 2014 Kelpie Round-Up

7/27/2014

PackLeader Farm

Sunday, July 20, 2014

AHBA

Event# 2014KelpieC

---

HTAD3 III Ducks Judge: David Larson

---

1/74 **6304** **Chesta's Isis of Callaway HRDIs HRDIIs HTADId HTADIIIs HTDIs RLFIIIs (Isis)**  
AKC PAL257146, DOB: 10/19/2009, Border Collie, Sex: F, Breeder: Unknown Sire: Unknown Dam: Unknown  
Owner(s): Ashley Wright, 2605 North Winnifred Rd., Tacoma WA 98407

---

HTAD3 II Ducks Judge: David Larson

---

NQ **6208** **Frost-King Carma HRDIIs HTADIsd HTDId RLFIs HRDIc HTADIIIs (Carma)**  
AKC WS35129405, DOB: 7/19/2010, Rottweiler, Sex: F, Breeder: Pamela Frost Sire: BISS CH Pepperhaus  
Praetorian CD Dam: Frost-King Bewitched HRDIs HTADId HSApsc Owner(s): Pamela Frost, 23110 NE Chelatchie Rd,  
Amboy WA 98601

---

HTAD3 I Ducks Judge: David Larson

---

1/67.5 **6133** **CLK Rooster JHD HTDIs HTADIs (Rooster)**  
NAAKR K04409, DOB: 1/2/2010, Australian Kelpie, Sex: M, Breeder: Kellp Orr Sire: Moo Hollow Twisp Dam: CLK  
Cooi Owner(s): Stephen Weigley, 14401 Crews Rd. KPN, Gig Harbor WA 98329 Handler: Barbara Davenport

---

## Trial Awards - Event 2014KelpieC

**HIT :** **96.0** **Kate (Kate)**  
4309 Course HTD III Ducks

**RHIT:** **93.5** **Miss Madison Rae (Maddie)**  
3323 Course HTD III Sheep

---

## JULY 20<sup>th</sup>, 2014 – CATTLE Course #2

### GENERAL RULES:

- Time 20 minutes.
- In all elements, quiet efficient stock work is essential.
- All elements must be attempted prior to moving on.
- All gates may be open/closed or pre-set at the Handler's discretion to increase safety
- Time will not end until all gates have been restored to their original/starting position.
- Ties are broken based on individual scores in the following order: Exercise 4 "Small Pens", Exercise 1 "Take Pen", Time.

### STARTING SET- UP:

- All gates must be returned to the starting positions.
- 5 cows in Stockyard, 5 cows in Side Pen A, 5 cows in Arena B, and 5 cows in reserve resting (stock handler will advance this group in rotation).
- For HRDIII Only, the gate between the Alleyway and P2 will be preset open for sort.

1. **TAKE PEN – 10 pts.:** Enter Arena A through designated 4' gate. Exercise begins when gate to Pen 1 is opened. Gather (5) cows from the Stockyard and move into Arena A. Exercise ends when gate to Arena A is closed.
2. **FETCH/DRIVE – 30 pts.:** Exercise begins when Gate to Arena A is closed. HRDI & II - Move the cows from the gate through Obstacle #1, clockwise around the Freestanding Pen. HRDIII – Move the cows from the gate through Obstacle #1, clockwise around the designated Post and through Obstacle #2. Exercise ends when the cows have cleared the plane of Obstacle #2.
  - **HRDI** Handler may move anywhere
  - **HRDII** Handler remains at Handler's Post until the cows exit Obstacle #1.
  - **HRDIII** Handler remains in the Advanced Handler's zonet until the cows have passed behind the cone.
3. **HRDIII ONLY: SORT – 10 pts.:** Exercise begins when cows clear the plane of Obstacle #2. Sort 3 cows into Pen #2 and attached alleyway. Briefly close gate, then pen remaining cows in Alleyway. Exercise ends when the Arena A gate is closed. (Pen#2 should have no cows in before exercise #4.)
4. **SMALL PENS – 20 pts.:** Exercise begins when gate to Side Pen A is opened. Move cows from Side Pen A through Pen #2 and release in Back Alley. Retrieve cows from Arena A (HRDI & II) or Alleyway (HRDIII) and pen in Side Pen A. Exercise ends when Side Pen A gate is closed. (Handlers should pre-set gates at Pen #3 prior to entering Arena B).
5. **GATHER – 15 pts.:** Exercise begins when Side Pen A gate is closed. Enter Arena B through Pen #3. Gather (5) cows and proceed to Pen #3. Move cows through Pen #3 and release in Footbath Alley. Exercise ends when the gate between Footbath Alley and Pen #3 is closed.
  - **HRDI** Dog is left approximately halfway to cow's position, Handler may move within 15 feet of cows
  - **HRDII** Dog is left at the Handler's Post, Handler may move ½ way.
  - **HRDIII** Team begins at the Handler's Post, where the Handler remains until the dog is sent. Once the dog is sent, the handler should remain in the advanced handler zone..
6. **RE-PEN - 15 pts.:** Exercise begins when the gate between Footbath Alley and Pen #3 is closed. Gather/move cows from Back Alley through Pen #3 and release them into Arena B. Exercise ends when the gate to Arena B is closed.

Time stops when **ALL** gates have been restored to their original/starting position.

2014 Kelpie Round-Up  
AHBA HRD – CATTLE Course #2

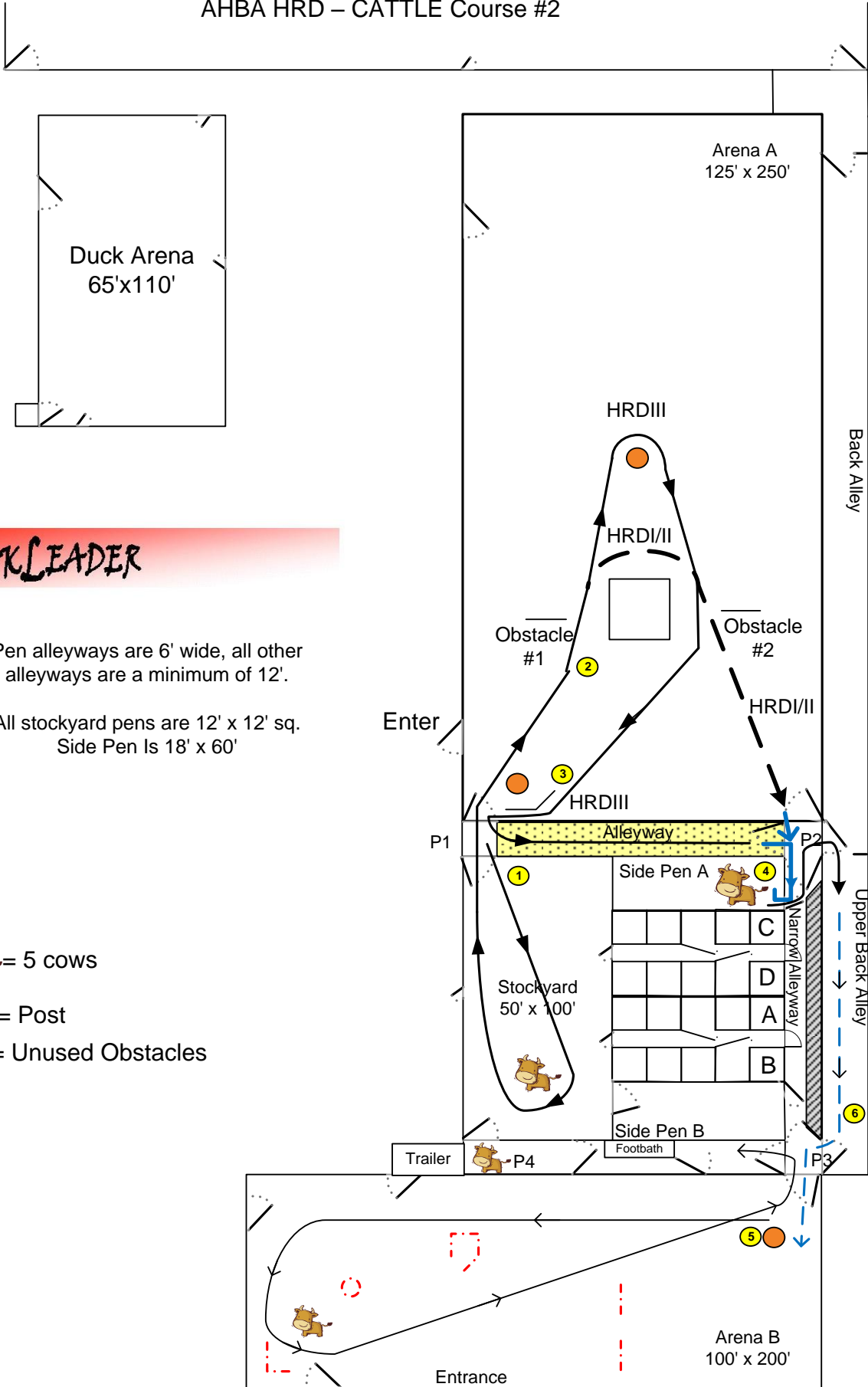

Pen alleyways are 6' wide, all other alleyways are a minimum of 12'.

All stockyard pens are 12' x 12' sq.  
Side Pen Is 18' x 60'

= 5 cows

= Post

= Unused Obstacles



## PackLeader Farm

**OTHER TRIAL AWARDS****Award: High Combined Advanced Dog**

Award Desc:	Set of coasters with photographic artwork by Dave Larson
Sponsor:	Dave Larson
Eligibility Requirements:	Advanced Classes
Computation Method:	Total single highest score per DATE, for all STOCK, COURSES and CLASSES specified
Qualifying Scores?	N

Call Name	Dog Name	Date of Birth	Breed	Sex	Score
<b>Cosmo</b>	Frost-King Cosmo	7 /19/2010	Rottweiler	F	<b>278.0</b>
		Owner: Frost, Pamela	Handler: Frost, Pamela		

**Award: High Combined Intermediate Dog**

Award Desc:	Set of coasters with photographic artwork by Dave Larson
Sponsor:	Dave Larson
Eligibility Requirements:	Intermediate Classes
Computation Method:	Total single highest score per DATE, for all STOCK, COURSES and CLASSES specified
Qualifying Scores?	N

Call Name	Dog Name	Date of Birth	Breed	Sex	Score
<b>Boomer</b>	DeHaro's Boomerang	3 /30/2011	Australian Kelpie	M	<b>248.5</b>
		Owner: Madamba, Shari	Handler: Madamba, Shari		

**Award: High Combined Started Dog**

Award Desc:	Set of coasters with photographic artwork by Dave Larson
Sponsor:	Dave Larson
Eligibility Requirements:	Started Classes
Computation Method:	Total single highest score per DATE, for all STOCK, COURSES and CLASSES specified
Qualifying Scores?	N

Call Name	Dog Name	Date of Birth	Breed	Sex	Score
<b>McGee</b>	CLK Oakley	12/15/2009	Australian Kelpie	F	<b>238.5</b>
		Owner: Wright, Ashley	Handler: Wright, Ashley		

**Award: Kelpie - High Combined HRD**

Award Desc:	Kelpie Belt Buckle (Buckle design by Kathy Green. Buckle crafted by Wages Silversmiths)
Sponsor:	PackLeader Farm
Eligibility Requirements:	Must be a Kelpie entered in HRD classes
Computation Method:	Top 3 HRD scores for the weekend
Qualifying Scores?	N

Call Name	Dog Name	Date of Birth	Breed	Sex	Score
<b>Tori</b>	Marionvale Tori	11/20/2009	Australian Kelpie	F	<b>249.5</b>
		Owner: Davenport, Barbara	Handler: Davenport, Barbara		

# 2014 Kelpie Round-Up

7/27/2014

## PackLeader Farm

### Award: Kelpie - High Combined HTD/HTAD

Award Desc:	Braided Stock Stick (House of Rawhide)
Sponsor:	PackLeader Farm
Eligibility Requirements:	Must be a Kelpie entered in HTD/HTAD classes
Computation Method:	Single highest score per DATE, for all STOCK, COURSES and CLASSES specified
Qualifying Scores?	N

Call Name	Dog Name	Date of Birth	Breed	Sex	Score
Boomer	DeHaro's Boomerang	3 /30/2011	Australian Kelpie	M	248.0
		Owner: Madamba, Shari	Handler: Madamba, Shari		

### Award: Other Breed - High Combined

Award Desc:	Kelpie Belt Buckle (Buckle design by Kathy Green. Buckle crafted by Wages Silversmiths)
Sponsor:	Toni Crites, Dreamcatcher Kennel
Eligibility Requirements:	Must be a Non Kelpie
Computation Method:	Top 2 scores each day, any course/stock for the weekend
Qualifying Scores?	N

Call Name	Dog Name	Date of Birth	Breed	Sex	Score
Kate	Kate	3 /20/2010	Border Collie	F	534.5
		Owner: Kelly, Kelly L.	Handler: Kelly, Kelly L.		

## 2014 Kelpie Round-Up

7/27/2014

PackLeader Farm

**HIGH SCORING BREEDS - INFORMATIONAL ONLY**

Computation Method: Each Day 7/18/2014 to 7/18/2014

Breed	Score	Call Name	Dog Name	DOB	Sex	Owner	Handler
Australian Cattle	83.5	Bean	The Bean	10/25/2005	F	Rice, Jen	Rice, Jen
Australian Kelpie	84.5	Tori	Marionvale Tori	11/20/2009	F	Davenport, Bar	Davenport, Barb
Australian Shepherd	90.0	Jillian	Legends I Hope You Dance	1 /6 /2011	F	Doyle, Raenell	Doyle, Raenell
Border Collie	94.5	Isis	Chesta's Isis of Callaway	10/19/2009	F	Wright, Ashley	Wright, Ashley
German Shepherd	93.0	Singer	Alta Tollhaus Just a Singer	12/24/2009	M	Godfrey, Richa	Godfrey, Richar
Rottweiler	94.5	Carma	Frost-King Carma	7 /19/2010	F	Frost, Pamela	Frost, Pamela

Computation Method: Each Day 7/19/2014 to 7/19/2014

Breed	Score	Call Name	Dog Name	DOB	Sex	Owner	Handler
Australian Cattle	89.5	Koz	Aquila's Forbidden Kosciuszk	3 /29/2007	F	Murray, Paul	Murray, Paul
Australian Kelpie	93.0	Tempe	High Country Tempest	11/15/2008	F	Davenport, Bar	Davenport, Barb
Australian Shepherd	87.0	Jillian	Legends I Hope You Dance	1 /6 /2011	F	Doyle, Raenell	Doyle, Raenell
Border Collie	97.0	Louie	Louie	2 /9 /2009	M	Rice, Jen	Rice, Jen
German Shepherd	85.5	Singer	Alta Tollhaus Just a Singer	12/24/2009	M	Godfrey, Richa	Godfrey, Richar
Rottweiler	93.5	Cosmo	Frost-King Cosmo	7 /19/2010	M	Frost, Pamela	Frost, Pamela

Computation Method: Each Day 7/20/2014 to 7/20/2014

Breed	Score	Call Name	Dog Name	DOB	Sex	Owner	Handler
Australian Cattle	88.0	Bindi	WZ I've Got A Secret	4 /6 /2008	F	Murray-Gann,	Gann, Kelly
Australian Kelpie	92.0	Denali	HighCountry Denali	11/15/2008	M	Larson, David	Larson, David
Australian Shepherd	89.5	Jillian	Legends I Hope You Dance	1 /6 /2011	F	Doyle, Raenell	Doyle, Raenell
Border Collie	96.0	Kate	Kate	3 /20/2010	F	Kelly, Kelly L.	Kelly, Kelly L.
German Shepherd	85.5	Singer	Alta Tollhaus Just a Singer	12/24/2009	M	Godfrey, Richa	Godfrey, Richar
Rottweiler	90.5	Cosmo	Frost-King Cosmo	7 /19/2010	M	Frost, Pamela	Frost, Pamela



# PACKLEADER

Gig Harbor, WA



**2013** Ashley Wright & CLK Oakley (McGee)

**2014** Barbara Davenport & Marionvale Tori (Tori)

**2015** ??????? Who will it be?

**Mark your calendars for the 2015 Kelpie Round-up!  
July 17/18/19, 2015**